

## Modular Jack Top Entry H=16.7 W=16.0 For Category 6

### Material&Finish

Housing: Glass Fiber, UL 94V-0, Black  
 Contact :0.35mm Thickness Phosphor Bronze,  
 Gold Plating Over Nickel on Contact Area,  
 Tin Plating Over Nickel on Solder Area.

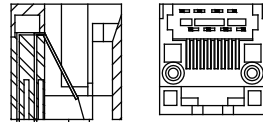
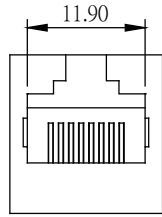

Without Copper Plate

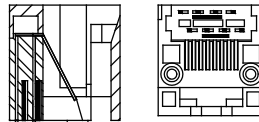

Copper Plate

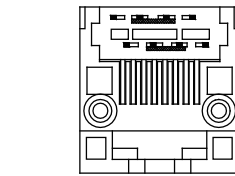
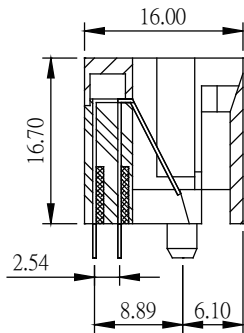
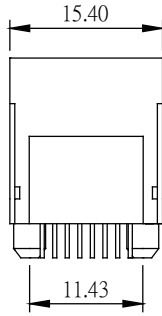
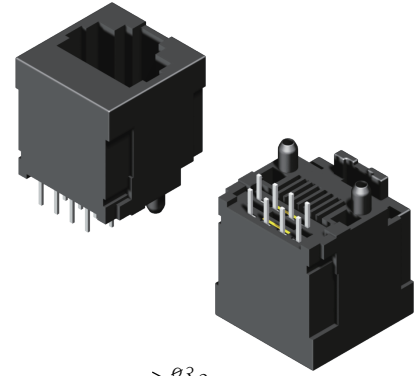

Copper Plate With Mylar Inside

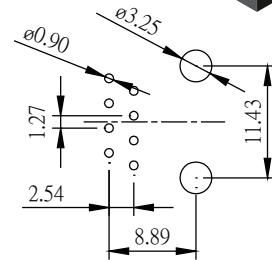

Recommended PCB Layout  
(PCB TOLERANCE ±0.05)

### Order Information

5 R J 1 D S 0 0 N 0 N - 8 8 X X 0 0 L - 232 - A X

- 5: N:W/O Ear
- R: Number of Positions (8:8 Positions)
- J: Number of Contacts (8:8 Contacts)
- 1: S0: Selective flash
- D: SA: Selective 6u"
- S: SB: Selective 10u"
- 0: SC: Selective 20u"
- 0: SD: Selective 30u"
- N: SF: Selective 15u"
- 0: S5: Selective 50u"
- N: L: RoHS + PBT+Tray
- : Series No.
- 8: 1: Without Copper Plate
- 8: 2: Copper Plate Inside
- X: 3: Copper Plate with Mylar Inside

Old P/N: 232N-8P8C

## Modular Jack Side Entry H=15.7 W=20.5

### Material&Finish

Housing: P.B.T, UL 94V-0, Black  
 Contact :0.35mm Thickness Phosphor Bronze,  
 Gold Plated Over Nickel on Contact Area.

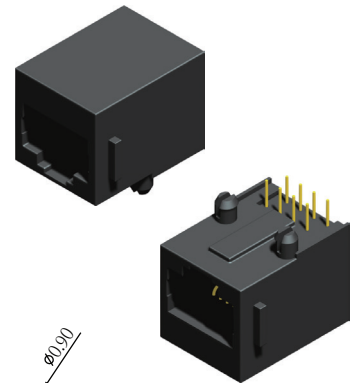
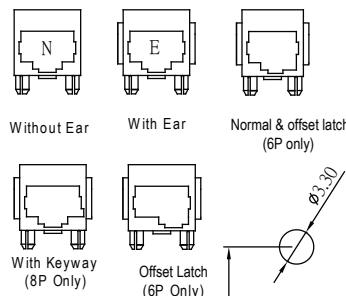
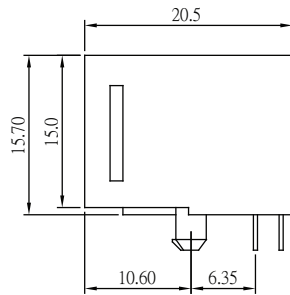
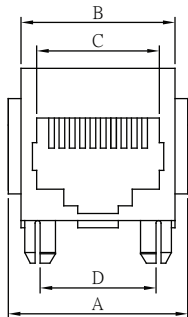

Positions	Contacts	A	B	C	D
4P	4C	13.70	11.20	7.70	7.62
6P	2C/4C/6C	15.75	13.20	9.90	10.16
8P	4C/6C/8C	17.70	15.20	11.95	11.43
10P	10C	17.70	15.20	11.95	11.43

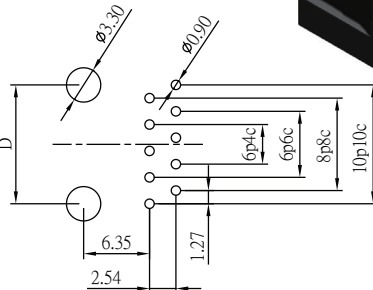

Recommended PCB Layout  
(PCB TOLERANCE ±0.05)

### Order Information

5 R J 1 D R 0 0 N 0 X - X X X 0 0 L - 240 - A X

- 5: N:W/O Ear
- R: E: With Ear
- J: Number of Positions (4:4 Positions, 6:6 Positions, 8:8 Positions, A:10 Positions)
- D: Number of Contacts (2:2 Contacts, 4:4 Contacts, 6:6 Contacts, 8:8 Contacts, A:10 Contacts)
- R: S0: Selective flash
- 0: SA: Selective 6u"
- 0: SB: Selective 10u"
- L: SC: Selective 20u"
- : SD: Selective 30u"
- X: SF: Selective 15u"
- X: S5: Selective 50u"
- 0: L: RoHS + PBT+Tray
- 0: Series No.
- : 1: Standard
- A: 2: With Keyway(8P Only)
- X: 3: Offset Latch(6P Only)
- X: 4: Normal & Offset Latch (6P Only)

Old P/N: 240X-XPXC