

## BF2 MINI Blade Fuse



### FEATURES:

- 32 VDC blade fuse
- Rated Current: 3-30 A
- Breaking Capacity: 1 kA at 32 VDC
- Standards: UL 275A
- Approvals: UL (File: E499007)
- Tolerance: ref. to UL 275A; ISO 8820-3

### ELECTRICAL SPECIFICATIONS

Part Number	Rated Current	Ampere Code	Housing Color	Rated Voltage	Breaking Capacity	I <sup>2</sup> t (A <sup>2</sup> s)	Certifications UL
BF21300300	3 A	1300	Violet	32 VDC	1 kA@32 VDC	9.5	●
BF21400300	4 A	1400	Pink			17.5	●
BF21500300	5 A	1500	Tan			25.5	●
BF21750300	7.5 A	1750	Brown			68.8	●
BF22100300	10 A	2100	Red			93.2	●
BF22150300	15 A	2150	Blue			270.2	●
BF22200300	20 A	2200	Yellow			380.8	●
BF22250300	25 A	2250	Natural			625.5	●
BF22300300	30 A	2300	Green			1130.1	●

Note: (1) Temperature rise: <50 K.

### PART NUMBER SYSTEM

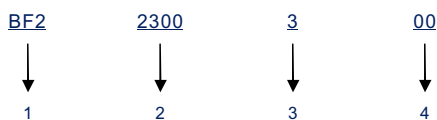

- 1..... Product Series ..... BF2  
 2..... Ampere Code ..... 30 A (see Ampere code column of electrical specifications)  
 3..... Rated Voltage ..... 3: 32 VDC  
 4..... Supplementary Code ..... 00: default

### DIMENSIONS (mm)

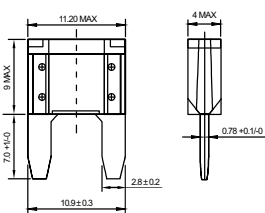

### TIME CURRENT CURVE

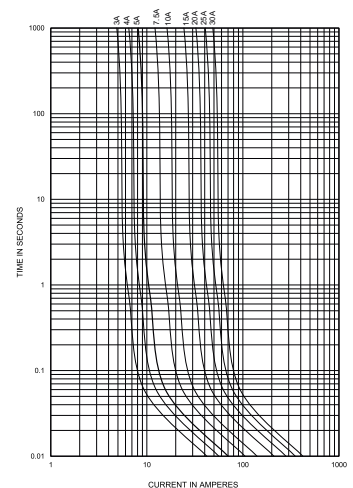

### TIME VS CURRENT CHARACTERISTIC

Rated Current	110 %	135 %	200 %	350 %	600 %
3-30 A	>100 h	0.75-1800 s	0.15-5 s	40-500 ms	20-100 ms