

North America: Danboro, PA • E-mail: info@pemnet.com • Tel: +1-215-766-8853

Europe: Galway, Ireland • E-mail: europe@pemnet.com • Tel: +353-91-751714

Asia/Pacific: Singapore • E-mail: singapore@pemnet.com • Tel: +65-6-745-0660
Shanghai, China • E-mail: china@pemnet.com • Tel: +86-21-5868-3688

Part # MSIB-M1.6-300, microPEM® Symmetrical, Thru-Threaded, Types MSIA™, MSIB™

- Threads as small as M1.
- Symmetrical design eliminates the need for orientation.
- Provides excellent performance in wide range of plastics.
- Aluminum inserts offer light weight, lead-free alternative.

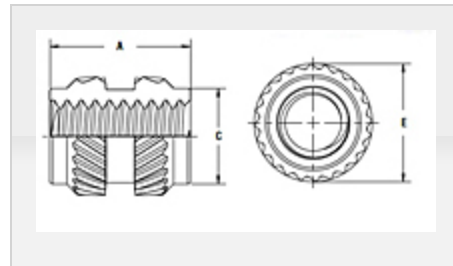
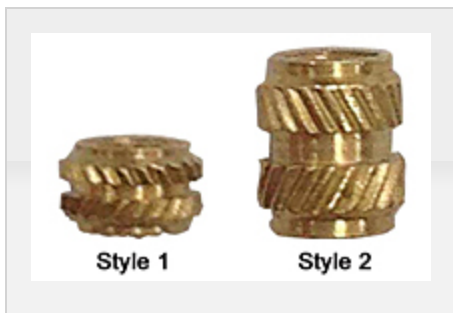

Specifications

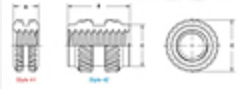
Thread Size x Pitch	M1.6 x 0.35
Thread Code	M1.6
Type	MSIB
Length Code	300
Style	#2
A ±0.1	3 mm 
E ±0.1	2.5 mm
C Max.	2.15 mm
Min. Wall Thickness¹	0.8 mm

Min. Mounting Hole Depth	3.77 mm
Mounting Hole Dia. +0.05/-0.00	2.15 mm
Thread Specification	Metric ASME B 1.13M, 6H
Fastener Material	Free-Machining, Leaded Brass
Standard Finish	Plain
CAD Supplier	PennEngineering® (PEM®)

¹ Refers to wall diameter of boss as tested in ABS and polycarbonate.