

7902 Series

Slim D-SUB Right Angle Type

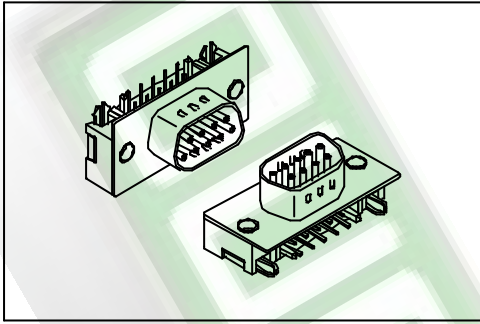

Material:

Housing: High temperature housing UL94V-0 withstands IR and VPR soldering methods.

Contacts: Phosphor Bronze.

Plating: Selective Gold plated.

Electrical Characteristics:

Current Rating: 1 AMP.

Insulator Resistance: 5000M Ω min. at DC 500V.

Contact Resistance: 20m Ω max. at DC 100mA.

Operating Temperature: -65°C ~ +125°C.

Max Processing Temperature: 230°C for 30~60 seconds.

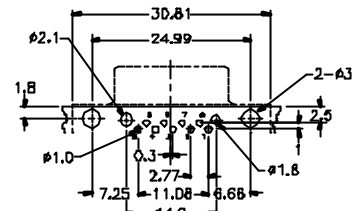
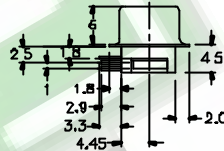
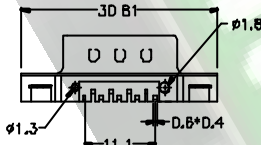
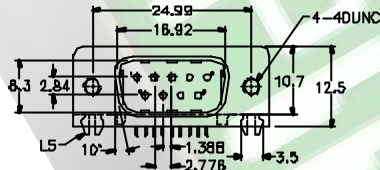

Footprint 1 P.C. Board Layout
7902-09MCR1/L5

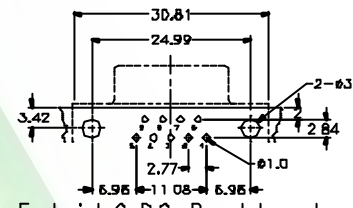
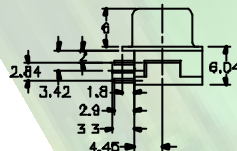
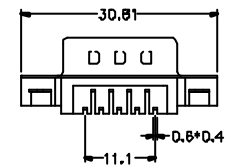
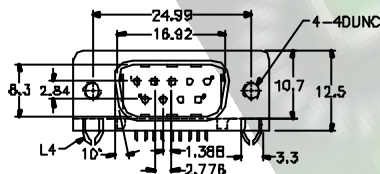

Footprint 2 P.C. Board Layout
7902-09MCR2/L4

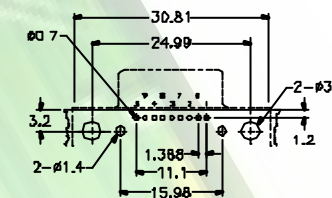
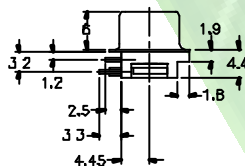
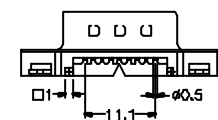
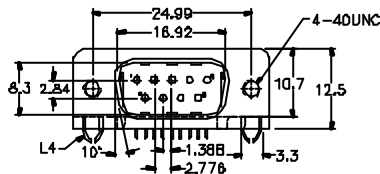

Footprint 3 P.C. Board Layout
7902-09MCR3/L4

Ordering information

7902-	09	M	C	R	1	/L4
Series	Position	Male	C: Selective Gold Plated	R: Right Angle	1: Footprint 1	Lock Type See Above
					2: Footprint 2	
					3: Footprint 3	