

7906 Series

D-SUB Right Angle Type

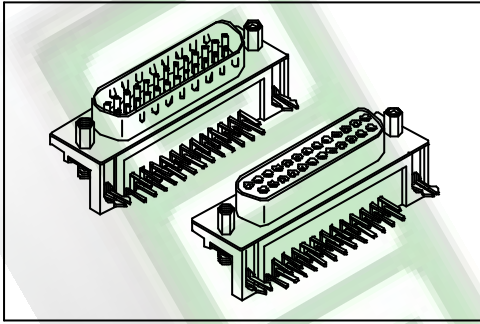

Material:

Housing: 30% Glass filled PBT UL94V-0.

Contacts: Brass.

Plating: Gold plated.

Electrical Characteristics:

Current Rating: 1 AMP.

Insulator Resistance: 5000M Ω min. at DC 500V.

Contact Resistance: 20m Ω max. at DC 100mA.

Operating Temperature: -55°C ~ +105°C.

Features:

* UL cUL Listing.

Mates with: 7907, 7908.

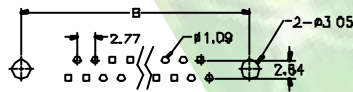
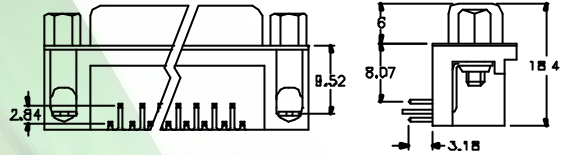
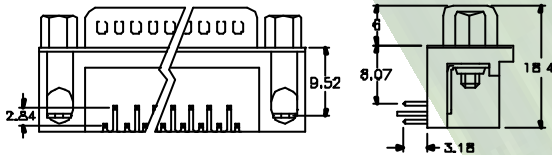
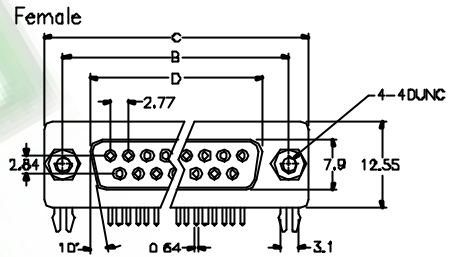
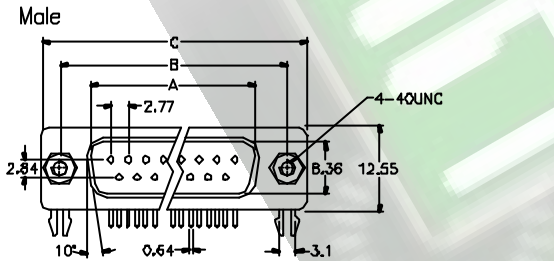

P.C. Board Layout

Position	Dimension			
	A	B	C	D
9	16.92	24.99	30.81	16.33
15	25.25	33.32	39.14	24.66
25	38.96	47.04	53.04	38.38
37	55.42	63.60	69.32	54.84

Ordering information

7906- 37 M A
 Series Position M: Male A ~ Z. See Page B58 ~ B61
 F: Female