



过温保护

OVER TEMPERATURE PROTECTION

更好的电路安全卫士!
You build electronics, We safeguard them!

2021
Product Portfolio



贝特卫士®
www.betterfuse.com

目录

Contents



公司简介 Our Company	02
公司发展历程 Company History	03



OT(Over-Temperature) Thermal Protection

产品应用领域 Product Application	04
-------------------------------	----

OT-F (一次性熔断温度保险丝)

BTT 系列温度保险丝 BTT Series Thermal Fuse	05
BTA 系列温度保险丝 BTA Series Thermal Fuse	06
BTB 系列温度保险丝 BTB Series Thermal Fuse	07
BTC 系列温度保险丝 BTC Series Thermal Fuse	08
BTW 系列温度保险丝 BTW Series Thermal Fuse	09
术语说明/组合部件及二次加工品/安装注意事项 The Term / Combined Parts And Secondary Products / Installation Instructions	10

OT-S (可恢复式温度开关)

KSD02热保护器系列 KSD02 Thermal Protector series	11-12
KSD05热保护器系列 KSD05 Thermal Protector series	13-14
ATM系列热切断器 ATM Thermal cut - out series	15-16
KST系列可调式温控器 KST Thermostat series	17-18
BTU系列复合保护 BTU SERIES MULTIPLE PROTECTION	19



董事长寄语 CEO Address	20
----------------------	----

公司简介

OUR COMPANY

Incorporated in 2003 on the foundations of the German WICKMANN' S factory in Dongguan, Better Group established and secured its the leader position on fuse industry as a manufacturer for total circuit protection components and brand operators in China.

Our product portfolio consists of fuses and components for over-current, over-voltage and over-temperature protection and related accessories, which are approved and certified through major international testing laboratories, such as TUV, VDE, UL, CSA, CCC, PSE, KC and ASTA. Accessed to the certification of ISO9001/ISO14001/ISO080000/IATF16949 quality management. Has won the recognition from domestic and overseas famous enterprises, like Midea, Haier, BYD, ZTE, Samsung, Panasonic, and has established long-term and friendly cooperation relationship.

In the electronics, electricity, new power and industrial circuit protection market, in order to meet different safety requirements and localization service, We has respectively set up multiple overseas offices and agencies In Asia, Europe and America.

For many years, We experienced mergers and acquisitions, recombination and upgrade. It started from a small workshop and has developed till now. Taking the Dongguan Songshanhu Bettel headquarter as the maternal and subordinating 8 branches, Betterfuse is a national high-tech enterprise. Through the targets and principles, like optimizing talents, platform integration, flat management, two-oriented integration, Betterfuse continuously improves core competitiveness of enterprises.

Under the guidance of the company's five core ideas "Brand, Teamwork, Energy, Efficiency, Resources", with solid technical strength, We has implemented related systems, Introduced ERP, OA and other related systems, and prospectively introduced MES, SPC, TPM ect advanced intelligent manufacturing management software. Keep pace with times so that to provide faithful and value-added services for the global clients.

东莞市贝特电子科技股份有限公司于2003年系原德国百年品牌 WICKMANN(东莞)中国团队创办, 公司定位全面电路保护元件制造商和方案顾问, 目前已成为中国区行业领跑品牌。

我们的产品包含过流, 过压, 过温电路保护元件和复合产品以及相关配件, 已经取得TUV、VDE、UL、CSA、CCC、PSE、KC、ASTA等认证。公司已取得ISO9001, ISO14001, ISO080000, IATF16949等体系认证。赢得了美的, 海尔, 比亚迪, 中兴通讯, 三星, 松下等国内外知名企业的认可, 并建立了长期友好合作关系。

在电子、电力、新能源和工业电路保护市场上, 为满足各种不同的安全技术要求和本土化服务, 我们在亚洲、欧洲和美洲分别设立多个海外驻点办事处和代理机构。

多年来, 我们历经了并购、重组、升级。从一个小车间开始, 发展至今, 以贝特卫士东莞松山湖总部为母体下辖8家分子公司的国家高新技术企业, 通过优化人才、平台整合、扁平化管理、两化融合等方针和目标, 不断提升企业核心竞争力。

在“品牌、活力、团队、效率、整合”企业五大核心理念的指引下, 我们以雄厚的技术实力, 导入了ERP, OA等相关系统, 并前瞻性的引入MES, SPC, TPM等先进智能制造管理软件, 与时俱进, 为全球客户提供诚信、增值的服务。



Company History

- 2021** Import OA, SPC system
导入OA、SPC系统
- 2020** The found of Dongguan ADLER Electric Co., Ltd
The found of Dongguan ELB electrical Co., Ltd.
东莞三厂正式成立
东莞市艾乐贝电子有限公司成立
- 2019** Dongguan Betterfuse second branch was officially established
MES & U9 system running
The found of Dongguan Advonsoon Automation Co., Ltd. Dongguan Bxway Electronics Co., Ltd.
东莞贝特卫士第二分公司正式成立
MES和U9系统运行
东莞市艾德迅自动化有限公司, 东莞市贝芯微电子有限公司成立
- 2018** In round C financing, Shenzhen Dachen Chuangye Investment, Shenzhen co-win venture capital investment limited, China Venture Capital Inc. and other investment companies invest 30,000,000RMB.
Obtain IATF 16949 system certification
C轮融资达晨、同创伟业、中国风险等投资资金3000万。
取得IATF 16949体系认证
- 2017** In round B financing, Shenzhen hi-tech investment co., ltd and other three investment company invest 31,000,000RMB.
Joint venture of Xi'An ADLER electric appliance.
The first batch of Pilot enterprise of "Income Doubling Program" in Dongguan.
Establish CPC Better Guardian party branch
B轮融资深圳高新投等四家风投3100万,
合资成立西安艾德乐电器
东莞市首批“倍增计划”试点企业、中共贝特卫士党支部成立
- 2016** Successfully landed the Chinese OTC Market and acquired the qualification of the intellectual property management system certification
贝特卫士成功登陆新三板, 获得“知识产权管理体系认证”资质
- 2015** Obtained the certification of "Engineering Research Center of Circuit Protection Components in Guangdong Province"
取得“广东省电路保护元件工程技术研究中心”资格认定
- 2014** Accessed to the certification of ISO 14001 and QC 080000 quality management system and successfully registered "Betterfuse" brand trademark as "贝特卫士", which pronounced similar to "Betterfuse"
通过“ISO 14001”和“QC 080000”质量管理体系认证,
成功注册“贝特卫士”品牌商标
- 2012** Completion of the stock reform, obtain angel investment foundation 10 million
股改完, 引入天使投资汇通盈富1000万
- 2011** Accessed to the qualification of "high-tech enterprise"
获得“高新技术企业”资质
- 2010** Successively merged with Asiafuse (HK) Electronics Limited, Wholesome Electronics Co., Ltd., Tronic Electronics Limited., Waltron Electronic Co., Ltd.,
先后并购艾弗电子(香港)公司, 宏立信电子, 创领电子, 华创电子
- 2007** Accessed to "ISO 9001" quality management system certification
获得“ISO 9001”质量管理体系认证
- 2003** August, Betterfuse came into being in the ruins of Wickman's factory, which was took over by Littlefuse
正式注册“东莞市贝特电子科技有限公司”

企业核心理念
Company's Core Philosophy



Note: The above certification marks show a summary of all available product certification, each product's own specific certifications shall prevail.

产品应用领域

PRODUCT APPLICATION

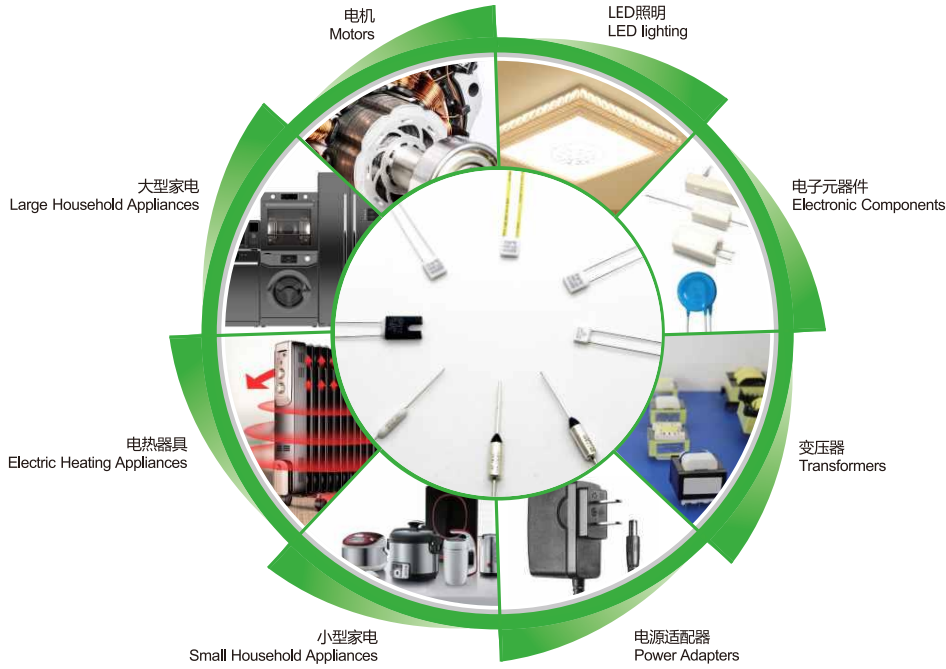

■ OT-F产品应用领域: OT-F products applications:

- LED照明
Led Lighting
- 变压器
Transformers
- 电源适配器
Power Adapters
- 电子元器件
Electronic Components,
- 大型家电
Large Household Appliances
- 小型家电
Small Household Appliances
- 电热器具
Electric Heating Appliances,
- 电机
Motors

■ OT-S产品应用领域: OT-S products applications:

- LED照明
LED Lighting
- 变压器
Transformer
- 电动机
Motor
- 蓄电池
Battery
- 电吹风
Hair Dryer
- 暖风机
Heater
- 电烤箱
Oven
- 充电器
Charger



BTT系列温度保险丝 BTT SERIES THERMAL FUSE



关键特性 KEY FEATURES OF THE PRODUCT

- 有机化合物型
Product of organic compound type
- 温度带丰富 (73-240C)
Temperature band is rich (73-240C)
- 动作温度精准
Accurate action temperature
- 一次动作保护, 不可恢复
Not recoverable

尺寸 DIMENSIONS(MM)

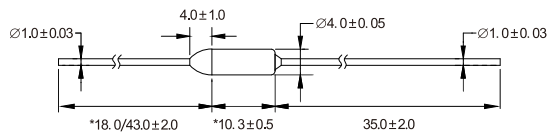

备注: 导线长度可根据客户要求定制
Note: Wire length can be customized according to customer requirements.

工作原理 WORKING PRINCIPLE

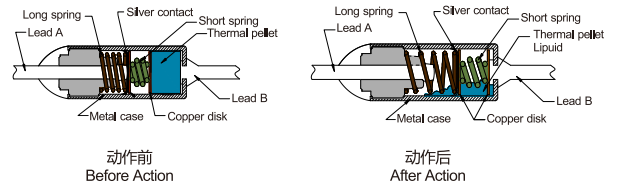

当温度保险丝本体及周边环境温度上升至有机化合物熔点时, 化合物由固态变为液态, 在弹簧弹力作用下, 推开触点起到切断电流作用。
When fuse body and its ambience temperature rises to the melting point of the organic compound, the compound changes from solid state to liquid state. Under the action of spring elasticity, the contact is pushed off to cut off the current.

参数表 PARAMETER LIST

序号 No.	料号 PN	额定 动作温度	动作 温度	保持 温度	极限 温度	额定 电流	额定 电压	认证					
		Tf (°C)	Operating temperature (°C)	Th (°C)	Tm (°C)	Rated Current (A)	Rated Voltage (V)	UL/C-UL	CCC	TUV	PSE	VDE	KC
1	BTT0**073	73	69±2	57	180	10A 15A	250VAC	●	●	●	●	●	●
2	BTT0**077	77	72±2	62	180	10A 15A	250VAC	●	●	●	●	○	●
3	BTT0**084	84	80±3	69	180	10A 15A	250VAC	●	●	●	●	○	●
4	BTT0**094	94	91+3-2	78	180	10A 15A	250VAC	○	●	●	●	○	●
5	BTT0**099	99	95±2	83	180	10A 15A	250VAC	●	●	●	●	●	●
6	BTT0**113	113	108+2-3	95	180	10A 15A	250VAC	●	●	●	●	●	●
7	BTT0**121	121	117±3	106	180	10A 15A	250VAC	●	●	●	●	●	●
8	BTT0**128	128	124±3	113	200	10A 15A	250VAC	●	●	●	●	○	●
9	BTT0**133	133	129+3-2	118	200	10A 15A	250VAC	●	●	●	●	●	●
10	BTT0**142	142	138±3	127	200	10A 15A	250VAC	●	●	●	●	●	●
11	BTT0**152	152	150+1-3	137	210	10A 15A	250VAC	○	○	○	○	○	○
12	BTT0**157	157	152±2	138	200	10A 15A	250VAC	●	●	●	●	●	●
13	BTT0**167	167	164±2	153	250	10A 15A	250VAC	○	○	○	○	○	○
14	BTT0**172	172	168±3	153	230	10A 15A	250VAC	●	●	●	●	●	●
15	BTT0**184	184	180±2	159	210	10A 15A	250VAC	●	●	○	●	●	○
16	BTT0**192	192	189±2	177	320	10A 15A	250VAC	●	●	●	●	●	●
17	BTT0**216	216	213±3	200	380	10A 15A	250VAC	●	●	●	●	●	●
18	BTT0**229	229	225±2	200	380	10A 15A	250VAC	●	●	●	●	○	○
19	BTT0**240	240	235±2	210	380	10A 15A	250VAC	●	●	●	●	●	●

注: (1)**-对应10A或15A
(1)**: Response 10A or 15A
(2)●=取得○=未取得
(2)●=obtained ○=no obtained

BTA系列温度保险丝 BTA SERIES THERMAL FUSE

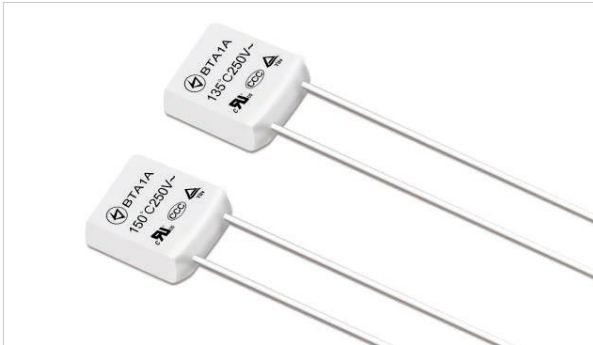

关键特性 KEY FEATURES OF THE PRODUCT

- 环保易熔合金型
Environmentally fusible alloy type
- 塑料外壳
Plastic case
- 动作温度精准
Accurate action temperature
- 一次动作保护, 不可恢复
Not recoverable

尺寸 DIMENSIONS(MM)

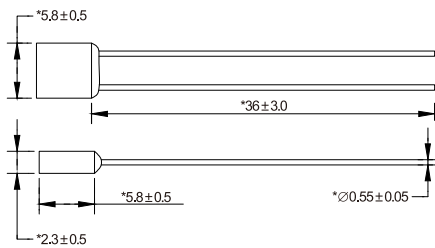

备注: 导线长度可根据客户要求定制
Note: Wire length can be customized according to customer requirements.

工作原理 WORKING PRINCIPLE

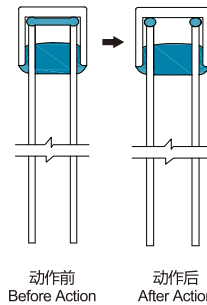

当温度保险丝本体及周边环境温度上升至温度保险丝熔断温度时, 在助熔剂发挥表面张力作用下, 合金呈球状熔断, 切断电路, 发挥保护功能。

When fuse body and its ambience temperature rises to the melting point of Thermal fuse, the alloy is spherical fused under the surface tension of flux, cutting off the circuit and playing a protective role.

参数表 PARAMETER LIST

序号 No.	料号 PN	额定 动作温度	动作 温度	保持 温度	极限 温度	额定 电流	额定 电压	认证 certification					
		Tf (°C)	Operating temperature (°C)	Th (°C)	Tm (°C)	Rated Current (A)	Rated Voltage (V)	UL/C-UL	TUV	CCC	PSE	KC	VDE
1	BTA 102C	102	98±2	80	203	1A	250V	●	○	●	○	○	○
2	BTA 115C	115	111±2	100	203	1A	250V	●	●	●	●	●	●
3	BTA 125C	125	121±2	106	203	1A	250V	●	●	●	●	●	●
4	BTA 130C	130	125±2	108	203	1A	250V	●	●	●	●	●	●
5	BTA 135C	135	131±2	116	203	1A	250V	●	●	●	●	●	○
6	BTA 145C	145	140±2	127	203	1A	250V	●	●	●	●	●	○
7	BTA 150C	150	144±2	129	203	1A	250V	●	●	●	●	●	○

注: (1) ●=取得 ○=未取得
(1) ●=obtained ○=no obtained



BTB系列温度保险丝 BTB SERIES THERMAL FUSE



关键特性 KEY FEATURES OF THE PRODUCT

- 环保易熔合金型
Environmentally fusible alloy type
- 塑料外壳
Plastic case
- 动作温度精准
Accurate action temperature
- 一次动作保护，不可恢复
Not recoverable



尺寸 DIMENSIONS(MM)

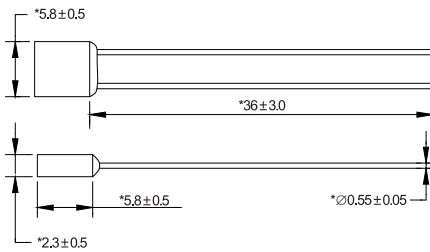

备注：导线长度可根据客户要求定制
Note: Wire length can be customized according to customer requirements.

工作原理 WORKING PRINCIPLE

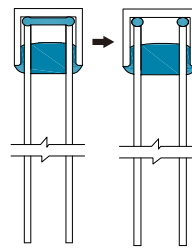

动作前 Before Action 动作后 After Action

当温度保险丝本体及周边环境温度上升至 温度保险丝熔断温度时，在助熔剂发挥表面张力作用下，合金呈球状熔断，切断电路，发挥保护功能。

When fuse body and its ambience temperature rises to the melting point of Thermal fuse, the alloy is spherical fused under the surface tension of flux, cutting off the circuit and playing a protective role.

参数表 PARAMETER LIST

序号 No.	料号 PN	额定 动作温度 Tf	动作 温度 Operating temperature	保持 温度 Th	极限 温度 Tm	额定 电流 Rated Current	额定 电压 Rated Voltage	认证 certification					
		(°C)	(°C)	(°C)	(°C)	(A)	(V)	UL/C-UL	TUV	CCC	PSE	KC	VDE
1	BTB 102C	102	98±2	80	203	2A	250VAC	●	○	●	○	○	○
2	BTB 115C	115	111±2	100	203	2A	250VAC	●	●	●	●	●	●
3	BTB 125C	125	121±2	106	203	2A	250VAC	●	●	●	●	●	●
4	BTB 130C	130	125±2	108	203	2A	250VAC	●	●	●	●	●	●
5	BTB 135C	135	131±2	116	203	2A	250VAC	●	●	●	●	●	○
6	BTB 145C	145	140±2	127	203	2A	250VAC	●	●	●	●	●	○
7	BTB 150C	150	144±2	129	203	2A	250VAC	●	●	●	●	●	○

注：(1) ●=取得 ○=未取得
(1) ●=obtained ○=no obtained

BTC系列温度保险丝 BTC SERIES THERMAL FUSE



关键特性 KEY FEATURES OF THE PRODUCT

- 环保易熔合金型
Environmentally fusible alloy type
- 塑料外壳
Plastic case
- 外壳U型结构，可螺栓固定安装
U Type case structure for bolt fixture
- 采用CP线，提高耐焊性
Adopt CP line to improve soldering performance
- 动作温度精准
Accurate action temperature
- 一次动作保护，不可恢复
Not recoverable

尺寸 DIMENSIONS(MM)

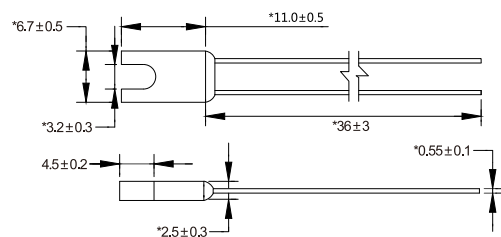

备注：导线长度可根据客户要求定制
Note: Wire length can be customized according to customer requirements.

工作原理 WORKING PRINCIPLE

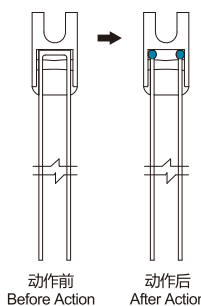

当温度保险丝本体及周边环境温度上升至 温度保险丝熔断温度时，在助熔剂发挥表面张力作用下，合金呈球状熔断，切断电路，发挥保护功能。

When fuse body and its ambience temperature rises to the melting point of Thermal fuse, the alloy is spherical fused under the surface tension of flux, cutting off the circuit and playing a protective role.

参数表 PARAMETER LIST

序号 No.	料号 PN	额定 动作温度	动作 温度	保持 温度	极限 温度	额定 电流	额定 电压	认证 certification				
		Tf (°C)	Operating temperature (°C)	Th (°C)	Tm (°C)	Rated Current (A)	Rated Voltage (V)	UL/C-UL	TUV	CCC	PSE	KC
1	BTC 115C	115	111±2	95	200	3A	250VAC	●	●	●	●	●
2	BTC 125C	125	121±2	106	203	3A	250VAC	○	○	○	○	○
3	BTC 130C	130	125±2	108	203	3A	250VAC	○	○	○	○	○
4	BTC 135C	135	131±2	116	203	3A	250VAC	○	○	○	○	○
5	BTC 145C	145	140±2	127	203	3A	250VAC	○	○	○	○	○
6	BTC 150C	150	144±2	129	203	3A	250VAC	○	○	○	○	○

注：(1) ●=取得 ○=未取得
(1) ●=obtained ○=no obtained



BTW系列温度保险丝 BTW SERIES THERMAL FUSE



关键特性 KEY FEATURES OF THE PRODUCT

- 环保易熔合金型
Environmentally fusible alloy type
- 陶瓷外壳
Ceramic case
- 动作温度精准
Accurate action temperature
- 一次动作保护, 不可恢复
Not recoverable

尺寸 DIMENSIONS(MM)

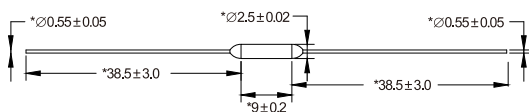

备注: 导线长度可根据客户要求定制
Note: Wire length can be customized according to customer requirements.

工作原理 WORKING PRINCIPLE

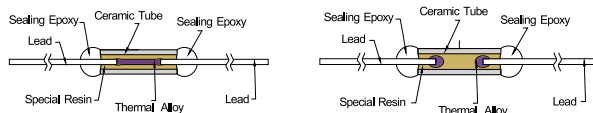

当温度保险丝本体及周边环境温度上升至 温度保险丝熔断温度时, 在助熔剂发挥表面张力作用下, 合金呈球状熔断, 切断电路, 发挥保护功能。
When fuse body and its ambience temperature rises to the melting point of Thermal alloy is spherical fused under the surface tension of flux, cutting off the circuit and playing a protective role.

参数表 PARAMETER LIST

序号 No.	料号 PN	额定 动作温度	动作 温度	保持 温度	极限 温度	额定 电流		额定 电压	认证 certification			
		Tf (°C)	Operating temperature (°C)	Th (°C)	Tm (°C)	Rated Current (A)		Rated Voltage (V)	UL/C-UL	TUV	CCC	PSE
1	BTW 115C	115	111±2	100	203	1	2	250VAC	○	○	○	○
2	BTW 125C	125	121±2	106	203	1	2	250VAC	○	○	○	○
3	BTW 130C	130	125±2	108	203	1	2	250VAC	○	○	○	○
4	BTW 135C	135	131±2	116	203	1	2	250VAC	○	○	○	○
5	BTW 145C	145	140±2	127	203	1	2	250VAC	○	○	○	○
6	BTW 150C	150	144±2	126	200	1	2	250VAC	●	●	●	●

注: (1) ●=取得 ○=未取得
(1) ●=obtained ○=no obtained

术语说明 THE TERM

额定动作温度(Tf) Rated Action Temperature	温度保险丝按照规定方法测试, 改变其导线状态的温度, 按照IEC60691, EN60691, UL60691等要求规定, 温度保险丝需在额定动作温度+0, -10°C范围内熔断, 日本电气用品安全法规定为±7°C。 Temperature fuses are tested in accordance with the prescribed method to change the temperature of the conductor state. According to IEC 60691, EN 60691, UL 60691 and other requirements, temperature fuses should be fused within the rated operating temperature of +0, -10 degree C. The Japanese Electrical Supplies Safety Law stipulates that the temperature fuses should be fused in the range of +7 degree C.
动作温度 Action Temperature	以1分钟0.5°C~1°C升温速率, 对产品本体施加10mA以下电流, 测得使温度保险丝断开的温度。 At the heating rate of 0.5 C 1 C per minute, the temperature of the fuse was measured through a current below 10 mA to the product body.
保持温度(Th) Holding Temperature	对保险丝施加额定电流, 连续168H不更改导电状态时所测量到的最高温度。 The rated current is applied to the fuse, and the highest temperature measured in continuous 168H is not changed.
极限温度(Tm) Ultimate Temperature	温度保险丝承受10分钟后不会发生重新接通现象的最高温度。 The temperature fuse will withstand to keep disconnected with the highest temperature after 10 minutes.

安装注意事项 INSTALLATION INSTRUCTIONS

- (1) 请勿将温度保险丝作为电流保险丝使用。
Do not use the temperature fuse as the current fuse.
- (2) 温度保险丝有规定额定范围（额定动作温度，额定电压，额定电流），请勿在额定范围外使用。
The temperature fuse has a specified rating range (rated action temperature, rated voltage, rated current). Please do not use it outside the rating range.
- (3) 请将温度保险丝设计在熔断后，不超过最高极限温度（TM）机器上使用。
Please design the temperature fuse for use on the machine with the maximum temperature (TM) not exceeding the maximum temperature (TM) after the fuse is broken.
- (4) 请勿将温度保险丝使用在水或有机溶液中，亚硫酸气体，氮氢化合物等腐蚀性气体及高温环境下使用；依据客户的使用要求，在选择温度保险丝时，需对安装的妥当性进行判断。
Do not use the temperature fuse in water or organic solution, sulfite gas, nitrogen and hydrogen compound and other corrosive gases and high-humidity environment. According to the customer use requirements, when selecting the temperature fuse, the installation of the appropriate judgment.
- (5) 使用过程中，请注意不要施加过度机械外力。
Please be careful not to apply excessive mechanical force during use.

※BTT有机化合物型产品请在距离外壳根部3mm，环氧树脂侧8mm以上进行导线弯折作业，弯曲过程中请固定导线（如下图），同时，对产品施加的机械外力勿超过下表。

※Type of products does the bluetail ticket tracker (BTT) organic compounds in a 3 mm case root, epoxy resin side more than 8 mm wire bending operations, in the process of bending please fixed wire (pictured), at the same time, external mechanical forces toward a product over the table below.

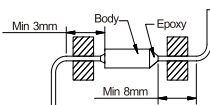

拉力 Tension	压力 Pressure	扭曲 Twist force
1.61KG	0.41KG	180° 1time

※BTA,BTB ,BTC ,BTW易熔合金型产品请在距离保险丝本体3mm以上进行导线弯曲作业，弯折过程请固定导线（如下图），勿使环氧树脂部位发生破裂。

※For BTA,BTB,BTC and btw fusing gold type products, please bend the wire more than 3mm from the fuse body. During the bending process, please fix the wire (as shown in the figure below), so as not to break the epoxy resin part.

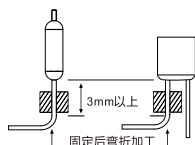

- (6) BTT系列使用过程需确保外壳无变形及损伤（外壳变形后，触点可能无法弹开最终导致产品无法发挥保护功能）。

During the use of btt series, it is necessary to ensure that the outer case is free from deformation and damage (after the outer case is deformed, the contact may not be able to be opened, resulting in the failure of the product to play the protective function).

- (7) BTT系列安装时，请勿使环氧树脂侧导线接触到产品外壳（一旦接触，可能导致电流从环氧树脂侧导线流向另一侧导线，无法切断电路）

The bluetail ticket tracker (btt) series when installation, please do not make epoxy wire in contact with the product side case (once the contact, may cause current flow from epoxy resin side wire to the other side of the wire, can't cut off the circuit)

- (8) 焊接时请勿过度加温于温度保险丝，请控制最低温度，最短时间进行焊接作业，在冷却过程，请勿动温度保险丝。

Do not overheat the thermal fuse when welding, please control the lowest temperature, the shortest time for welding operation, in the cooling process, do not move the temperature fuse.

※BTT系列保险丝若需要使用焊锡或浸锡方式安装时，需确保焊接位置距离保险丝本体大于10mm，焊接温度300度内时，焊接时间控制在1~2S内完成，Tf121以下产品建议不要使用焊锡或浸锡方式安装。

※ If the BTT series fuse needs to be installed with soldering tin or soldering tin, it shall ensure that the welding position is greater than 10mm from the fuse body, and when the welding temperature is with in 300 degrees, the welding time shall be controlled within 1-2s. Tf121 the following products are not recommended to be installed using soldering or immersion tin.

※ BTA,BTB ,BTC ,BTW易熔合金系列产品锡焊及浸锡焊接时可参照下表，尽可能延长导线焊接距离，焊接距离小于10mm时，建议使用散热辅助工具（如使用尖嘴钳夹住导线利于散热）；焊接后请放置30S以上后移动产品。

※ For the soldering and soldering of BTA,BTB,BTC and BTW fusing gold series products, please refer to the following table to extend the soldering distance of wires as far as possible. when the welding distance is less than 10mm, it is recommended to use the auxiliary tools for heat dissipation (for example, it is recommended to use the tongs to clamp the wires for heat dissipation). After welding, please place the mobile product for more than 30S.

额定动作温度 Tt	焊接距离 Soldering distance	焊接时间(S) ※300摄氏度时 Soldering time (300°C)
102-115	10mm	1
125-145	10mm	2
150	10mm	3

组合部件及二次加工品 COMBINED PARTS AND SECONDARY PRODUCTS



除向客户提供标准产品外，我们能够根据客户需求，定制组合件及各类规格的二次加工品，给客户带来便捷配套服务。

In addition to providing standard products to customers, we can customize the combination parts and secondary processing products of various specifications according to customers' needs to provide convenient supporting services to customers.

KSD02热保护器系列 KSD02 THERMAL PROTECTOR SERIES



关键特性 KEY FEATURES OF THE PRODUCT

- 体积小，便于安装
Small size, easy for installing
- PBT外壳，金属外壳，环氧树脂密封
PBT case, metal case, epoxy seal
- 自动复位双金属片，寿命高达10000次以上
Auto reset bimetallic strip, usage count more than 10000 times.
- 防潮，防尘，防浸漆
Moistureproof, dustproof, anti soaking paint
- 优越的热响应，电流温度双重保护
Superior thermal response, double protection for current & temperature
- 按要求定制
Customized base on customers & requirements



尺寸 DIMENSIONS(MM)

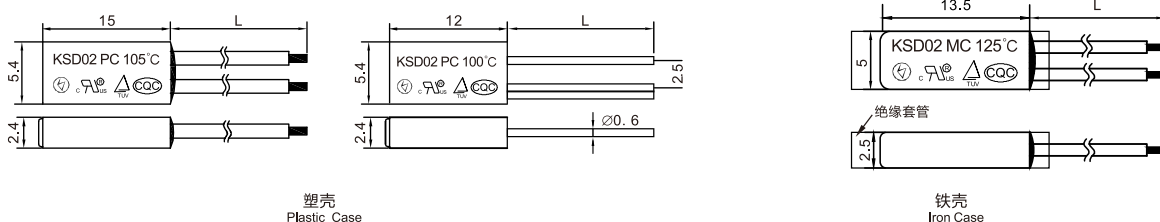

注：标准线材3266 22#白色线，线长L=70mm,电子线的型号规格、颜色、长度，套管规格、长度，镀锡铜线的长度等可依客户要求定制
Note: Standard wire is 3266 22# white wire, wire length is 70mm. The model specification/color/length/specification of tube/length of tin copper wire for electronic wire could be customized base on customers' requirements.

参数表 PARAMETER LIST

常闭
Often Close Type



动作前（触点接通）
Before Action (Contact Connection)



动作后（触点断开）
After Action (Contact Disconnection)

温度升高：热量传递到双金属片上，达到动作温度值，触点断开
温度下降：双金属片迅速恢复原状，触点闭合，电路接通

Temperature rise: Heat is transferred to bimetallic strip to reach the operating temperature value, and the contacts are disconnected.
Temperature drop: Bimetallic strip quickly restored to original state, contact closed and circuit connected.

注：常开型动作原理与此相反
Note: Normally open operating principle is opposite

电流-温度下降曲线图 OPERATING TEMP. DROP DUE TO CURRENT

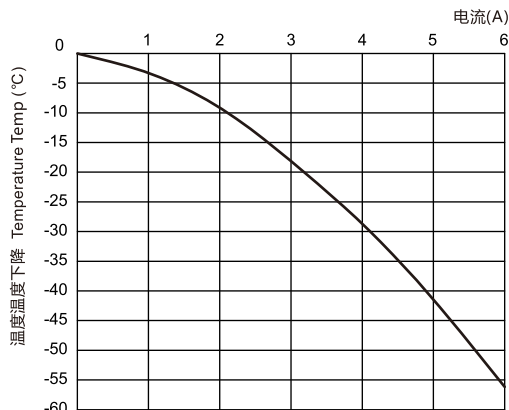

电流与时间曲线图 CURRENT AND TIME CURVE CHART

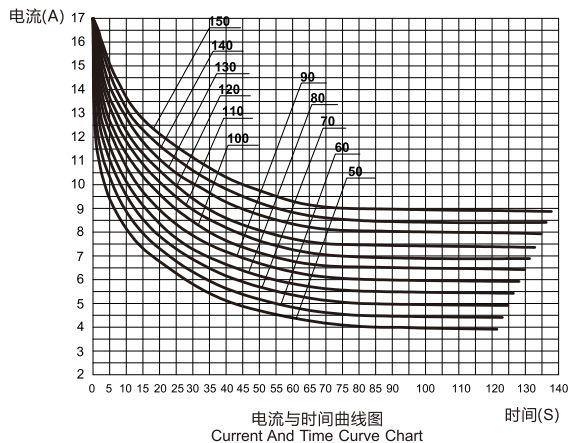

参数表 PARAMETER LIST

KSD02热保护器系列 KSD02 THERMAL PROTECTOR SERIES										
电气特性 Electric characteristic		AC250V/2A; AC115V/3A; DC48V/3A								
接触电阻 Contact resistance		≤50mΩ								
温度特性 Temperature characteristic										
料号 PN	动作温度(°C) Action temperature	复位温度(°C) Reset temp(°C)	最高使用环境 极限温度 Highest ambient temp	常闭 Often close		常开 Often open		认证 Certification		
				塑壳 Platic case	铁壳 Iron case	塑壳 Platic case	铁壳 Iron case	TUV	UL	CQC
KSD040****	40±5	≥30	90°C	●	●	●	-	●	●	●
KSD045****	45±5	≥33	95°C	●	●	●	-	●	●	●
KSD050****	50±5	≥35	100°C	●	●	●	-	●	●	●
KSD055****	55±5	42±6	105°C	●	●	●	-	●	●	●
KSD060****	60±5	45±8	110°C	●	●	●	-	●	●	●
KSD065****	65±5	48±10	115°C	●	●	●	-	●	●	●
KSD070****	70±5	50±12	120°C	●	●	●	-	●	●	●
KSD075****	75±5	53±14	125°C	●	●	●	-	●	●	●
KSD080****	80±5	55±15	130°C	●	●	●	-	●	●	●
KSD085****	85±5	60±15	135°C	●	●	●	-	●	●	●
KSD090****	90±5	65±15	140°C	●	●	●	-	●	●	●
KSD095****	95±5	70±15	145°C	●	●	●	-	●	●	●
KSD100****	100±5	70±15	150°C	●	●	●	-	●	●	●
KSD105****	105±5	75±15	155°C	●	●	●	-	●	●	●
KSD110****	110±5	75±15	160°C	●	●	●	-	●	●	●
KSD115****	115±5	80±15	165°C	●	●	●	-	●	●	●
KSD120****	120±5	85±15	170°C	●	●	●	-	●	●	●
KSD125****	125±5	85±15	175°C	●	●	●	-	●	●	●
KSD130****	130±5	90±15	180°C	●	●	-	-	●	●	●
KSD135****	135±5	95±15	180°C	●	●	-	-	●	●	●
KSD140****	140±5	100±15	180°C	●	●	-	-	●	●	●
KSD145****	145±5	100±15	180°C	●	●	-	-	●	●	●
KSD150****	150±5	105±15	180°C	●	●	-	-	●	●	●

注: (1) 复位温度仅供参考 (2) ●=取得 ○=未取得
 (1) Reset temp for reference (2) ●=obtained ○=no obtained

应用 APPLICATION

- | | | | |
|---------------------------------|-------------------------------------|--|---|
| (1) 电动机保护
Motor Protection | (3) 变压器保护
Transformer Protection | (5) 加热垫温度控制
Heating Pad Temperature Control | (7) LED灯管, 球泡保护
Led Lamp Tube, Bulb Protection |
| (2) 蓄电池保护
Battery Protection | (4) 充电器保护
Charger Protection | (6) 电源保护
Power Protection | (8) PCB电路板保护
Pcb Circuit Board Protection |

储存及安装注意事项 STORAGE AND INSTALLATION PRECAUTIONS

(1) 产品应在相对湿度小于90%，环境温度40°C以下通风、洁净、干燥、无腐蚀性气体的场所中存放。

The product should be stored in a ventilated, clean, dry and non-corrosive place with relative humidity less than 90% and ambient temperature below 40 °C.

(2) 保护器应安装于被保护对象温升的敏感点，其感温面应与被保护部件有效地紧密接触或直接面向被保护区域。

The protector shall be installed at the sensitive point of temperature rise of the protected object, and its temperature sensing surface shall be in close contact with the protected part effectively or directly oriented to the protected area.

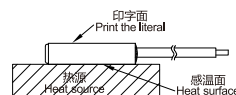

(3) 不得使用尖锐的工具对保护器挤压。

No sharp tools should be used to crush the protectors.

(4) 不得用重力捶压保护器。

Do not use gravity to beat the protector.

KSD05热保护器系列 KSD05 THERMAL PROTECTOR SERIES



关键特性 KEY FEATURES OF THE PRODUCT

- 体积小，快速动作
Small size, quick action
- PBT外壳，金属外壳，环氧树脂密封
PBT case, metal case, epoxy seal
- 自动复位双金属片
Auto reset bimetallic strip
- 防潮，防尘，防浸漆
Moistureproof, dustproof, anti soaking paint
- 优越的热响应
Superior thermal response
- 按要求定制
Customized according to requirements



尺寸 DIMENSIONS(MM)

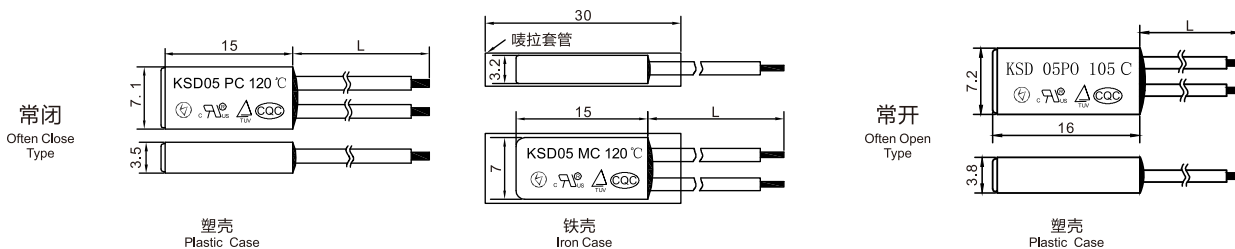

注：电子线的型号规格、颜色、长度，套管的规格、长度，镀锡铜线的长度等可依客户要求定制
Note: Type specification, color, length, sleeve specification, length of tin-plated copper wire can be customized according to customer requirements

参数表 PARAMETER LIST

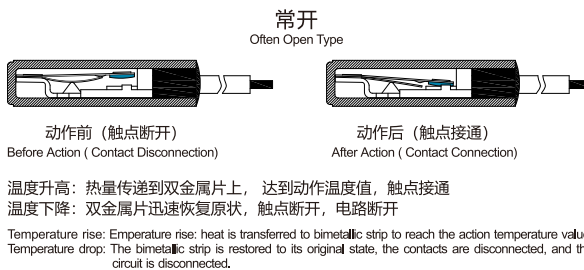
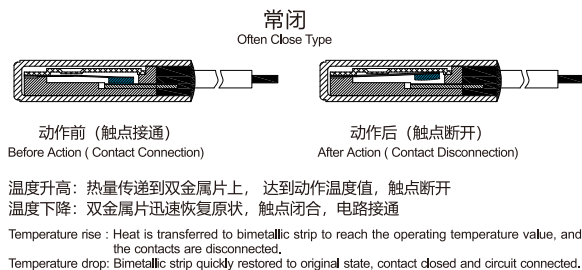

电流-温度下降曲线图 OPERATING TEMP. DROP DUE TO CURRENT

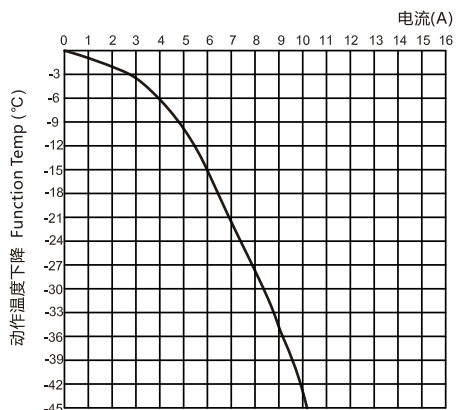

电流与时间曲线图 CURRENT AND TIME CURVE CHART

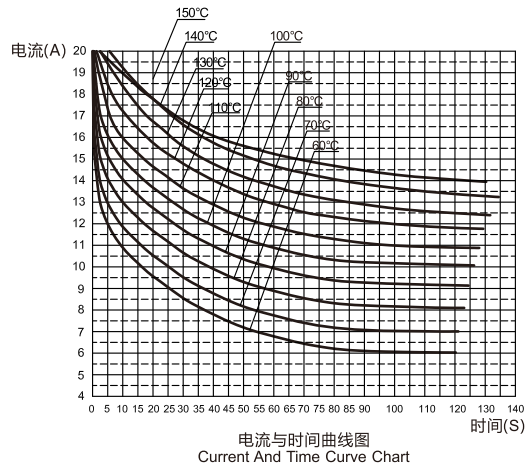

参数表 PARAMETER LIST

KSD热保护器系列 KSD THERMAL PROTECTOR SERIES										
电气特性 Electric characteristic		AC250V/5A; AC115V/8A; DC24V/10A								
接触电阻 Contact resistance		≤50mΩ								
温度特性 Temperature characteristic										
料号 PN	动作温度(°C) Action temperature	复位温度(°C) Reset temp(°C)	最高使用环境 极限温度 Highest ambient temp	常闭 Often close		常开 Often open		认证 Certification		
				塑壳 Platic case	铁壳 Iron case	塑壳 Platic case	铁壳 Iron case	TUV	UL	CQC
KSD060****	60±5	45±8	110°C			●	-	●	●	●
KSD065****	65±5	48±10	115°C	●	●	●	-	●	●	●
KSD070****	70±5	50±12	120°C			●	-	●	●	●
KSD075****	75±5	53±15	125°C	●	●	●	-	●	●	●
KSD080****	80±5	55±15	130°C			●	-	●	●	●
KSD085****	85±5	60±15	135°C	●	●	●	-	●	●	●
KSD090****	90±5	65±15	140°C			●	-	●	●	●
KSD095****	95±5	70±15	145°C	●	●	●	-	●	●	●
KSD100****	100±5	70±15	150°C			●	-	●	●	●
KSD105****	105±5	75±15	155°C	●	●	●	-	●	●	●
KSD110****	110±5	75±15	160°C			●	-	●	●	●
KSD115****	115±5	80±15	165°C	●	●	●	-	●	●	●
KSD120****	120±5	85±15	170°C			●	-	●	●	●
KSD125****	125±5	85±15	175°C	●	●	●	-	●	●	●
KSD130****	130±5	90±15	180°C			-	-	●	●	●
KSD135****	135±5	95±15	180°C	●	●	-	-	●	●	●
KSD140****	140±5	100±15	180°C			-	-	●	●	●
KSD145****	145±5	100±15	180°C	●	●	-	-	●	●	●
KSD150****	150±5	105±15	180°C			-	-	●	●	●

注: (1) 复位温度仅供参考
(1) Reset temp for reference
(2) ●=取得 ○=未取得
(2) ●=obtained ○=no obtained

应用 APPLICATION

- | | | | |
|---------------------------------|-------------------------------------|--|---|
| (1) 电动机保护
Motor Protection | (3) 变压器保护
Transformer Protection | (5) 加热垫温度控制
Heating Pad Temperature Control | (7) LED灯管, 球泡保护
Led Lamp Tube, Bulb Protection |
| (2) 蓄电池保护
Battery Protection | (4) 充电器保护
Charger Protection | (6) 电源保护
Power Protection | (8) PCB电路板保护
Pcb Circuit Board Protection |

储存及安装注意事项 STORAGE AND INSTALLATION PRECAUTIONS

- (1) 产品应在相对湿度小于90%，环境温度40°C以下通风、洁净、干燥、无腐蚀性气体的场所中存放。
The product should be stored in a ventilated, clean, dry and non-corrosive place with relative humidity less than 90% and ambient temperature below 40 °C.
- (2) 保护器应安装于被保护对象温升的敏感点，其感温面应与被保护部件有效地紧密接触或直接面向被保护区域。
The protector shall be installed at the sensitive point of temperature rise of the protected object, and its temperature sensing surface shall be in close contact with the protected part effectively or directly oriented to the protected area.

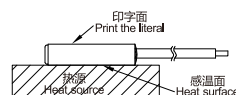

- (3) 不得使用尖锐的工具对保护器挤压。
No sharp tools should be used to crush the protectors.
- (4) 不得用重力捶压保护器。
Do not use gravity to beat the protector.

ATM系列热切断器 ATM THERMAL CUT - OUT SERIES



关键特性 KEY FEATURES OF THE PRODUCT

- 可承受16A大电流
May operation current 16A
- 10万次超长寿命
100,000 million times long life
- 快速动作
Quick action
- 优越的热响应
Superior thermal response
- 陶瓷耐高温支架
Ceramic high temperature resistant bracket



尺寸 DIMENSIONS(MM)

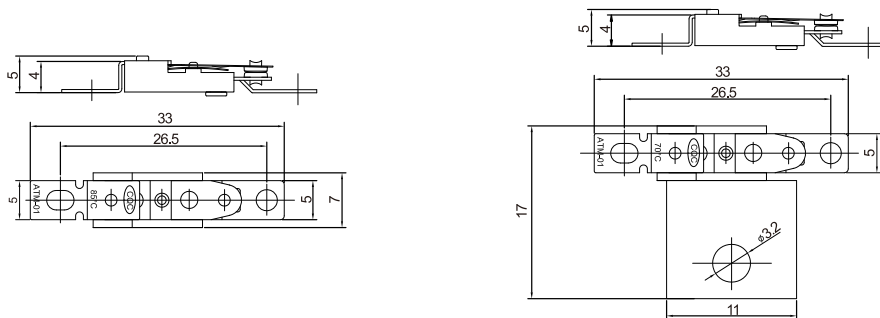

工作原理 WORKING PRINCIPLE

自动复位型(ATM-01)产品 Auto-Reset Type (ATM-01) Products



当被保护电器温度升高时所产生的热量传递到双金属片元件上，达到预定动作温度设定值时，双金属片元件便迅速动作，推动动触片断开触点，从而切断电路；当温度下降到额定复位温度值时，双金属片元件自动恢复接通电路。

When the temperature of the protected electrical apparatus rises, the heat generated is transferred to the bimetal sheet element, and when the predetermined operating temperature is reached, the bimetal sheet element acts quickly, pushing the moving contact to disconnect the contact, thereby cutting off the circuit; when the temperature drops to the rated reset temperature, the bimetal sheet element automatically restores the circuit to be connected.

断电复位型(ATM-01P)产品 Turn off to reset (ATM-01P) Products



带PTC元件同触点电路形成一个并联电路，当温度升高后，触点电路断开，电流通过PTC元件形成回路，PTC迅速升温，高于额定的复位温度，使电路一直保持断开状态。当关闭总电源，温度下降到双金片的复位温度时，双金片迅速恢复，触点闭合，使保护的电路更安全，更可靠。

When the temperature rises, the contact circuit is disconnected, and the current passes through the PTC element to form a circuit. The PTC temperature rises rapidly, which is higher than the rated reset temperature, so that the circuit remains disconnected. When the total power supply is switched off and the temperature drops to the reset temperature of the double gold sheet, the double gold sheet is quickly restored and the contacts are closed, thus making the protective circuit safer and more reliable.

电流热效应温度曲线图 TEMPERATURE CURVE OF ELECTRIC THERMAL EFFECT

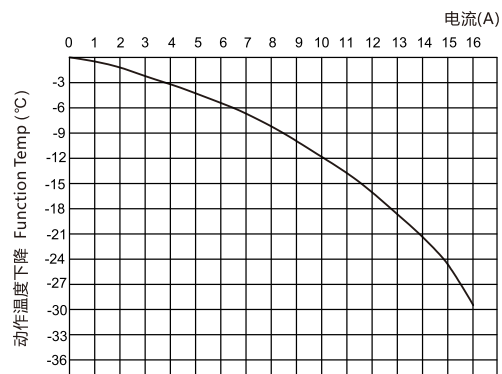

参数表 PARAMETER LIST

ATM系列热断路器 ATM THERMAL CUT - OUT SERIES								
电气特性 Electric characteristic		AC250V/16A 50/60HZ 10000cycles ; AC125V/16A 100000cycles ;						
接触电阻 Contact resistance		≤50mΩ						
温度特性 Temperature characteristic								
料号 PN	动作温度(°C) Action temperature	复位温度(°C) Reset temp(°C)	最高使用环境 极限温度 Highest ambient temp	常闭 自动复位 Often close (auto reset)	常闭 手动复位 Often close (manual reset)	认证 Certification		
						TUV	UL	CQC
ATM-01(01P)-60°C	60±5	45±8	110°C	●	●	●	●	●
ATM-01(01P)-65°C	65±5	48±10	115°C	●	●	●	●	●
ATM-01(01P)-70°C	70±5	50±12	120°C	●	●	●	●	●
ATM-01(01P)-75°C	75±5	53±15	125°C	●	●	●	●	●
ATM-01(01P)-80°C	80±5	55±15	130°C	●	●	●	●	●
ATM-01(01P)-85°C	85±5	60±15	135°C	●	●	●	●	●
ATM-01(01P)-90°C	90±5	65±15	140°C	●	●	●	●	●
ATM-01(01P)-95°C	95±5	65±15	145°C	●	●	●	●	●
ATM-01(01P)-100°C	100±5	70±15	150°C	●	●	●	●	●
ATM-01(01P)-105°C	105±5	75±15	155°C	●	●	●	●	●
ATM-01(01P)-110°C	110±5	75±15	160°C	●	●	●	●	●
ATM-01(01P)-115°C	115±5	80±15	165°C	●	●	●	●	●
ATM-01(01P)-120°C	120±5	85±15	170°C	●	●	●	●	●
ATM-01(01P)-125°C	125±5	85±15	175°C	●	●	●	●	●
ATM-01(01P)-130°C	130±5	90±15	180°C	●	●	●	●	●
ATM-01(01P)-135°C	135±5	95±15	185°C	●	●	●	●	●
ATM-01(01P)-140°C	140±5	100±15	190°C	●	●	●	●	●
ATM-01(01P)-145°C	145±5	100±15	195°C	●	●	●	●	●
ATM-01(01P)-150°C	150±5	105±15	200°C	●	●	●	●	●

注: (1) 复位温度仅供参考
(1) Reset temp for reference
(2) ●=取得 ○=未取得
(2) ●=obtained ○=no obtained

应用 APPLICATION

- (1) 电吹风、卷发器的过热保护
Overheating Protection For Hair Driers And Curlers
- (2) 加热器, 爆米花机, 电烤箱
Heater, Popcorn Maker, Electric Oven
- (3) 暖风机等
Heating Fan, Etc

储存及安装注意事项 STORAGE AND INSTALLATION PRECAUTIONS

- (1) 产品应在相对湿度小于90%，环境温度40°C以下通风、洁净、干燥、无腐蚀性气体的场所中存放。
The product should be stored in a ventilated, clean, dry and non-corrosive place with relative humidity less than 90% and ambient temperature below 40%.
- (2) 安装和使用过程中，绝不允许触碰弹片及感温部分，否则将会导致限温器温度失准，接触不良而不能工作。
In the process of installation and use, the shrapnel and the temperature sensing part must not be touched. Otherwise, the temperature of the thermostat will be inaccurate and the contact is not good enough to work.



KST系列可调式温控器 KST THERMOSTAT SERIES



关键特性 KEY FEATURES OF THE PRODUCT

- 温度可任意调节
The temperature can be adjusted at will.
- 多种形状可依客户需求定制
Various shapes can be customized according to customer requirements.
- 产品动作精准可靠
Accurate action temperature
- 使用寿命长(10万次)
Long service life (100,000 times)



尺寸 DIMENSIONS(MM)

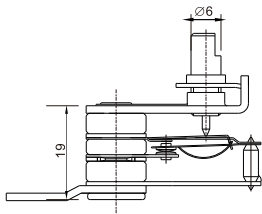

KST-A

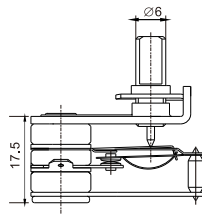

KST-B

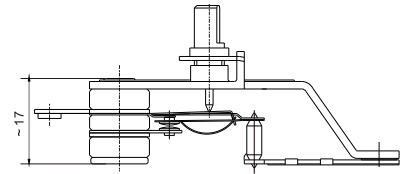

KST-C

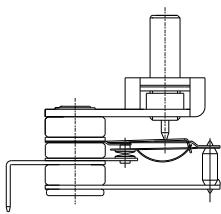
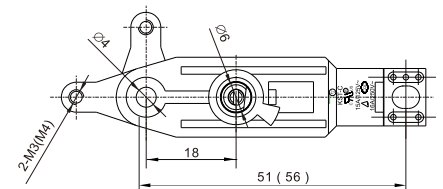
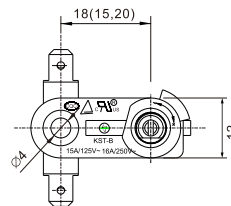
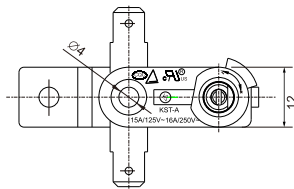

KST-D

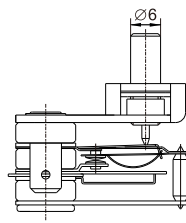

KST-R

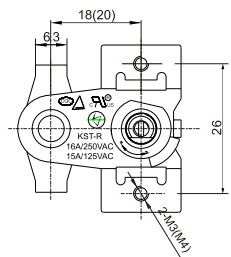
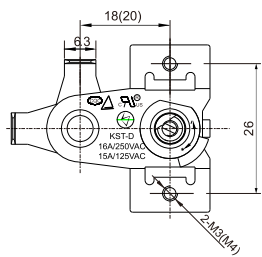

参数表 PARAMETER LIST

电气特性 Electric characteristic	AC250V/16A 100000cycles ; AC125V/15A 100000cycles ;
接触电阻 Contact resistance	≤50mΩ
触点形式 Contact model	常闭
产品标识 Product	KST-A安装板定位;KST-B 非安装板定位; KST-C 安装结构是桥式形状; KST-D 压板安装; KST-R 温控自带电阻补偿 KST-A assembly board fixture; KST-B none assembly board fixture; KST-C bridge type assembly structure; KST-D push board assembly; KST-R thermostat with resistance offset
使用环境极限温度 Lowest ambient temp	动作温度+50℃, 且最高不能超过300℃ 1分钟 Action temp 50℃, not high to 300℃
温度范围 temp range marking	0-250℃
温度公差 Temp intorance	±5℃ (≤100℃) ; ±5%℃ (> 100℃) 或依客户整机匹配 ±5℃ (≤100℃) ; ±5%℃ (> 100℃) according to client equipment to match
认证 Certification	UL、TUV、CQC

应用 APPLICATION

- (1) 电熨斗, 电烤箱, 油炸锅
Electric Iron , Electric Oven , Oil Fryer
- (2) 暖奶器, 热波炉, 光波炉, 电压力锅, 电饭煲
Milk Heater , Heat Wave Furnace , Light Wave Furnace, Electric Pressure Cooker , Electric Rice Cooke
- (3) 电饼铛、暖风机、BBQ等
Electric Baking Pan , Heater , BBQ , Etc

储存及安装注意事项 STORAGE AND INSTALLATION PRECAUTIONS

- (1) 产品应在相对湿度小于90%, 环境温度40℃以下通风、洁净、干燥、无腐蚀性气体的场所中存放
The product should be stored in a ventilated, clean, dry and non-corrosive place with relative humidity less than 90% and ambient temperature below 40%.
- (2) 为确保感温效果, 并在器具感温表面涂上导热膏
In order to ensure the temperature effect, and heat the paste on the surface of the instrument.
- (3) 安装时温控器的陶瓷、双金属片等物理状况应不受外力的作用而保持原样
When installing, the physical state of the ceramic and bimetal of the thermostat shall remain unchanged without external force.





BTU系列复合保护 BTU SERIES MULTIPLE PROTECTION

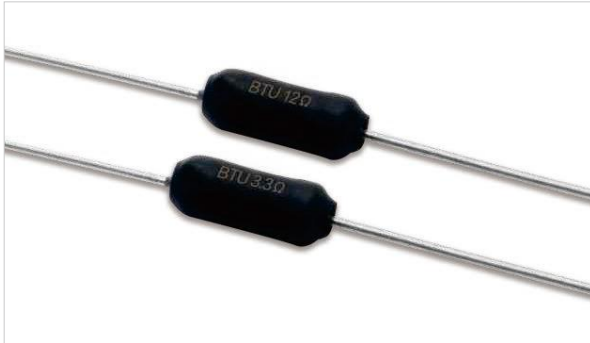

尺寸 DIMENSIONS(MM)

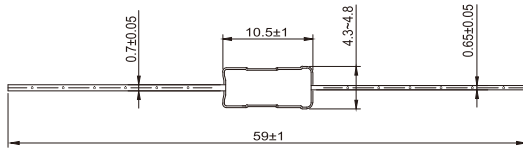

备注：导线长度可根据客户要求定制

Note: Wire length can be customized according to customer requirements.

关键特性 KEY FEATURES OF THE PRODUCT

- 过流&过温双重保护
Double protection of over current and over temperature
- 熔断电流小
Low fusing current
- 熔断时表面温度低
It have a low temperature on the surface during fusing.
- 电阻及温度保险丝动作温度可定制
Resistance and temperature fuse operation temperature can be customized

工作原理 WORKING PRINCIPLE

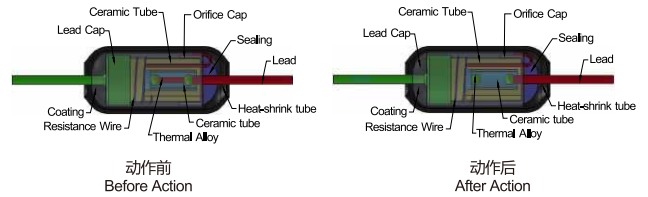

绕线电阻与温度保险丝结合体，当电阻因微短路时，表面温度持续上升，温度传导至温度保险丝设计温度时，保险丝熔断，发挥保护功能。

Wire winding resistance and temperature fuse combination, when the resistance due to micro short circuit, the surface temperature continues to rise, temperature conduction to the temperature fuse design temperature, fuse fuses, play the protection function.

参数表 PARAMETER LIST

序号 No.	料号 PN	功率 Power	电阻 (Ω)	电阻 公差 Resistance Tolerance	熔断 温度 Fusing Temperature (°C)	认证 certification		
						UL	TUV	CQC
1	BTU	0.5W	0.1-300	±5%	150+0-10	●	●	●
2	BTU	1W	0.1-300	±5%	221+0-10	●	●	●
3	BTU	2W	0.1-300	±5%	232+0-10	●	●	●

注：(1)电阻及熔断温度可定制

(1) Resistance and fuse temperature can be customized

(2)常用量产电阻规格：1.0Ω,1.1Ω,2.2Ω,2.8Ω,3.3Ω,4.3Ω,6.0Ω,22Ω

(2) Common use and could be volume production resistance specification: 1.0Ω,1.1Ω, 2.2Ω, 2.8Ω,3.3Ω,4.3Ω,6.0Ω,22Ω

应用 APPLICATION



电源适配器
The Power Adapter



LED灯
LED lights



电动牙刷座充
Electric toothbrush charger



无线A P
Wireless AP

董事长寄语

CEO ADDRESS

At the beginning of 2020, we overcame difficulties to back to the company in the reverse march. Just for the call of the company, all members of BETTERFUSE returned to the post from all over the country. Do you still remember the lofty sentiments that one of members of BETTERFUSE wrote in his doggerel during his return journey trip against wind and rain, and the courage of "the yellow flowers in the flame of war are especially fragrant" that our BETTER Communist Party of China presented during preventing and controlling the Covid-19? We were moving forward with our partners hand in hand and finally achieved good results with growth outperformed the average level of Dongguan City, the excess realization of the set target for the whole year.

At the beginning of the New Year of 2021, let us review the following five core concepts.

Brand:

The brand BETTERFUSE has gone deeper into the hearts of customers, and most production lines have made breakthroughs in terms of volume while the brand ADLER is shining in the international arena. It has entered the procurement catalog of many well-known brands and gained good recognition in the world. The two brands, BETTERFUSE and ADLER, are occupying an increasing market share. We see encouraging trends, the priority applications especially in 5G, new energy and other areas, which can reflect the brand occupancy fully.

Energy :

Under serious outbreak of Covid-19, our company is in first batch to resume production in Dongguan and form a considerable retrograde growth, which fully reflects the resilience and strength of the company's management. Under the precondition of well-done pandemic prevention measures, all kinds of strategic and tactical activities are done orderly as planned, such as factory celebration, exhibition, expansion of factory, community, recruitment, team building activities, which continues to inject vigor for the team, staff and brand.

Team:

Team has always been a key element of our core philosophy. We are constantly adapting our formation according to the external environment such as modular management start-up, specialization, accountability. In this New Year, the employee evaluation will be introduced in to our management and more high-quality professionals will be employed. The German team, Xi'an team, OT team, BXW team and ADS team are all constantly changing and eventually transforming into butterflies, forming their own professional team groups, which will make our business bigger and more stable.

Efficiency :

Efficiency is the top priority of all operation and management. After the painful strategic adjustment in the last two years, we climbed back up from the bottom of the valley and the business index recovered and surpassed the previous high level. The increased investment in IT hardware, software and system in the last two years will further promote the improvement of system efficiency.

Resource :

All members of BETTERFUSE are the resource integration in the very beginning of foundation. As the "Band of Brothers" model is our original DNA, so our resource sources are huge, and the system is relatively open and inclusive, just like a rapidly growing kapok tree. Our ADLER, ADS, ELB and all our subsequent merger and acquisition cooperation are based on the core concept of win-win coexistence with our upstream and downstream.

2020 has been a tough year, but we are pleased to see strong results and continued growth across our platforms.

Just as President Xi said, "Courage and perseverance are showed in difficulties, Jade is made after polished." We have overcome the impact of the pandemic, successfully completed in 2020, and planned for 2021. As the year is coming to an end, and new spring is approaching, the pandemic seems to be increasing globally. We pray for peace in the world, and 2021 will be an extraordinary year. We are confident to outburst, energize with all of you.

BETTERFUSE CEO David Han
2021.1 Dongguan

2020年开工伊始,我们就是在艰难中逆行出征,公司一声召唤全体贝特卫士从全国各地奔赴岗位,还记得那位写着打油诗风雨兼程赶路的兄弟的豪情吗,还得我们中共贝特支部同志们每天防控检测“战疫黄花分外香”的勇气吗?我们与各合作伙伴牵引前行……,最终取得了不俗的成绩,增长跑赢东莞平均水平,超越实现全年的既定目标。

2021年新春之初,我们一起回顾以下五大核心理念的践行情况。

品牌:

旗下品牌BTF更加深入客户之心,大部分产线刷新量的突破。旗下ADL在国际上更是大放异彩,已进入诸多知名品牌采购目录,在全球得到很好的认知,BTF和ADL的市占越来越大。我们看到了可喜的趋势,特别是在5G,新能源等领域的优先应用,更足以体现品牌的占位。

活力:

在严重的疫情挑战之下,我们做到东莞最早一批复工复产,并形成可观的逆增长,充分体现公司的管理的韧劲和强力,同时在做好防疫措施前提下,有序开展各项既定战略及内外战术行动,如期进行厂庆,参展,扩厂,社团,招聘,团建等活动,持续为团队、员工、品牌注入活力。

团队:

公司团队一直是我们的核心理念C位的要素,我们不断因应外部修正我们的阵形,模块化管理雏形启动,专业化,责任制。新年度我们还会与考核挂钩,不断引进更多高素质的专才,德国团队,西安团队,OT事业部团队,BXW事业部,ADS事业部均在不断蜕变最终脱蚕成蝶,形成各自专业的团队族群,这将让我们的事业·更大·更稳。

效率:

效率是所有经营管理的第一要义,我们经过前两年的剧痛的战略性调整,从谷底中从重爬上来,营业指标恢复并超越过去的高位,近两年加大投入IT软硬件和系统,将进一步促进系统效率的提升。

整合:

贝特卫士创立之初就是一种资源整合,“兄弟连”模式就是我们的原始DNA,故我们的资源来源宏大,体系相对开放包容,如同一棵快速长大的木棉花树。我们的ADL,我们的ADS,我们的ELB,我们的后续所有的并购合作均是出自此核心理念,与我们的上下游共赢共生。

2020年是异常艰辛的一年,但是我们很欣慰看到不错的运营结果旗下各平台正在发力持续增长……

正如习主席所说:“艰难方显勇毅,磨砺始得玉成”。我们也是克服疫情影响,2020圆满收官,2021全面擘画,岁末在即,新春将至,疫情好像又在全球加重,我们祝愿天下太平,2021年也必将是一个不平凡年份,我们有信心与大家一起“聚变,赋能”!

贝特卫士 CEO 韩露
2021年1月





National High-tech Enterprise
 SC 32C National Technical
 Committee Member of China
 ISO 9001 Certificated Company
 ISO 14001 Certificated Company
 QC 080000 Certificated Company
 IATF 16949 Certificated Company

国家高新技术企业
 SC 32C 国内专家组成员单位
 ISO 9001 认证企业
 ISO 14001 认证企业
 QC 080000 认证企业
 IATF 16949 认证体系

Headquarters 总部

东莞市贝特电子科技股份有限公司
 Add.:Room 601 of 16Block, No.1 Headquarters Velley, Hsinchu Road,Songshan Lake
 High-tech Industrial Development Zone.Dongguan city Guangdong Province P.R.C.
 Tel: +86-769-2307 8202 / 2307 8212
 Fax: +86-769-8352 1857
 Website: www.betterfuse.com
 地址: 广东省东莞市松山湖高新技术产业开发区新竹路总部一号, 16栋六楼



Website



Wechat public account

Subsidiaries 集团成员

贝特卫士 (香港)

Asiafuse (HK) Electronics Limited
 E-mail: davidhan@betterfuse.com

贝特卫士 (寮步)

Tel : +86-769-8323 8731 / 8323 8732 E-mail: sls01@betterfuse.com

贝特卫士 (佛山)

Tel : +86-757-82511089 / 82216739 E-mail: sls18@betterfuse.com

贝特卫士 (无锡)

Tel: +86-510-85296619 / 85228806 E-mail: jameszhou@betterfuse.com

贝特卫士 (台湾)

Tel: +886-921-617539 E-mail: sls29@betterfuse.com

Authorized Agent 特约经销商

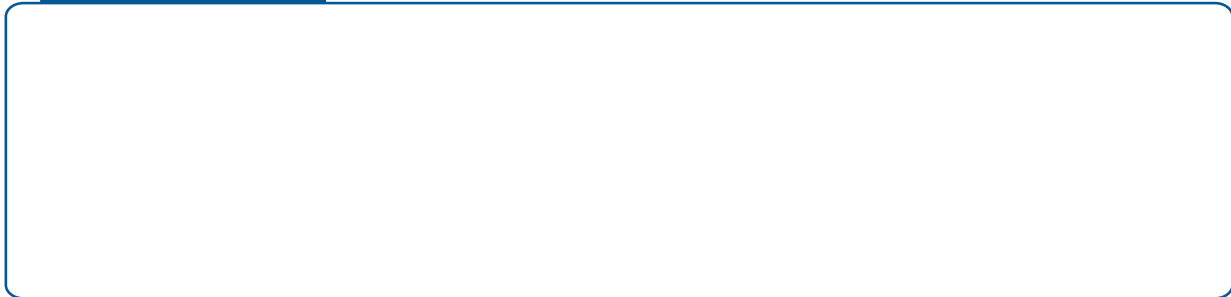

Note: The above ertification marks show a summary of all available product certification, each product's own specific certifications shall prevail.

► Ask for copies of our detailed product catalogs or visit our website at: www.betterfuse.com