

2257T-XXXX-XX

Part No	Wire Application	A	B	C	D
2257T-16-XX	16Awg	3.6	4.5	2.3	2.7
2257T-1824-XX	18~24Awg	3.6	4.5	1.9	2.3
2257T-2228-XX	22~28Awg	2.3	2.3	1.8	1.65



Specifications:

Current Rating:9.0A AC/DC  
 Voltage Rating:600V AC/DC  
 Contact Resistance:10M Ohm. Max.  
 Insulation Resistance:1,000M Ohm. Min.  
 Withstanding Voltage:1500V AC/Minute  
 Operating Temperature Range:-40°C ~ +105°C  
 Application Wire:Awg 16~28  
 Material And Finish:  
 Insulator:Nylon 66 (UL94V-2)  
 Color:Transparent White  
 Contact:Brass  
 Finish:Tin Plated  
 How To Order  
 2257-XX-XX

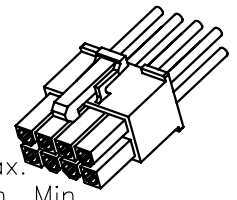

Blank V2 Material  
 V0:V0 Material  
 No. of Positions

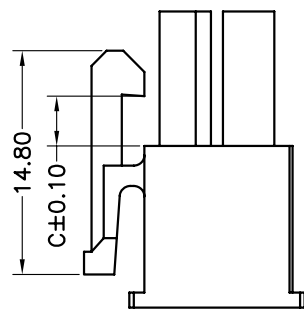
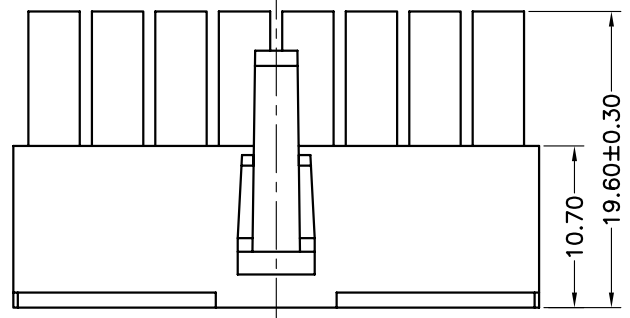
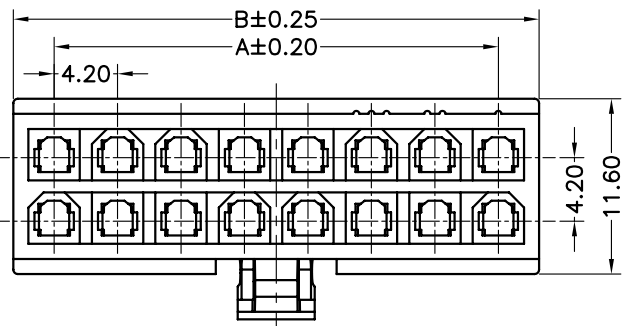

Dimension:

Circuits	DIM.A	DIM.B	DIM.C
2		5.40	3.30
4	4.20	9.60	3.30
6	8.40	13.80	3.30
8	12.60	18.00	3.30
10	16.80	22.20	3.30
12	21.00	26.40	3.30
14	25.20	30.60	3.30
16	29.40	34.80	3.30
18	33.60	39.00	3.60
20	37.80	43.20	3.60
22	42.00	47.40	3.60
24	46.20	51.60	3.60

RoHS Compliant

REV	DATE	FILE	BY
A	03-Nov-2008	(PC0001)	Tom
B	09-Jan-2010	ECN-CN1001006	Tom
C	15-DEC-2010	ECN-TW101204	Allen
D	11-Jan-2011	Add tolerance	Jeremy Liu

DRAWN: Tom	GENERAL TOLERANCE: .X=±0.25 .XX=±0.20
CHECKED: Jeremy Liu	UNIT: MM SCALE: 1:1
APPROVAL: Mike Wu	SHEET: 1 / 1 PROJECTION:



DESCRIPTION: 4.2mm Receptacle Housing	SIZE <b>A4</b>
PART NO: 2257-XX-XX	

1

2

3

4

5

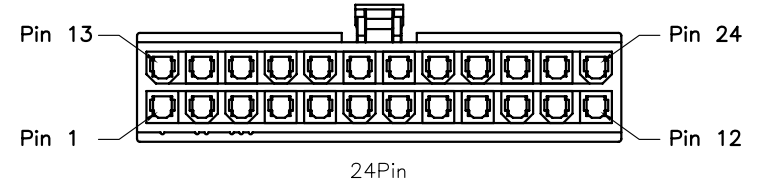
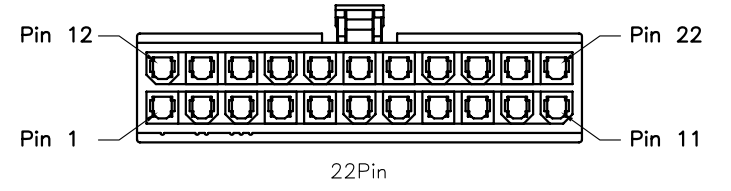
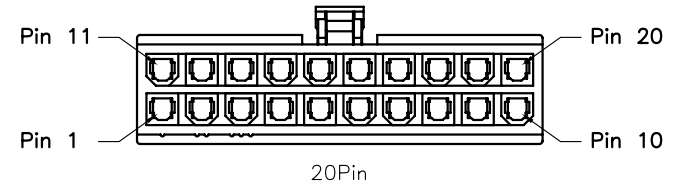
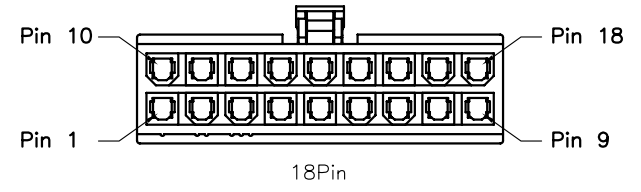
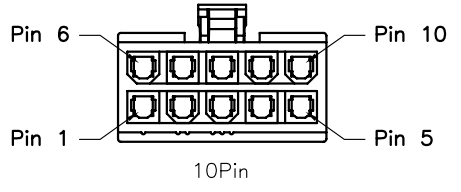
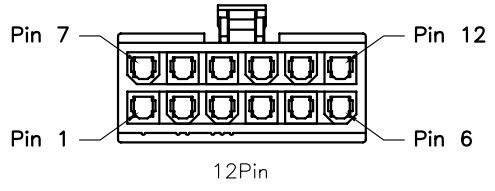
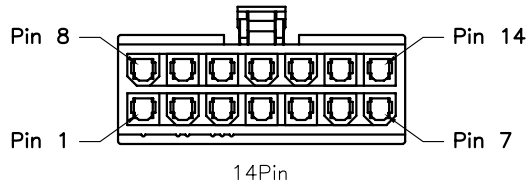
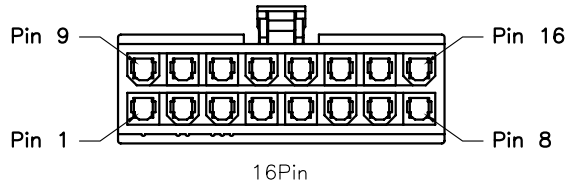
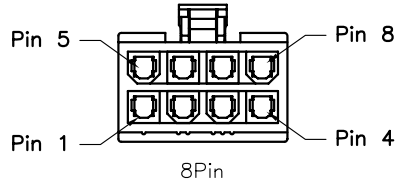
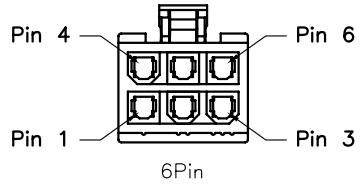
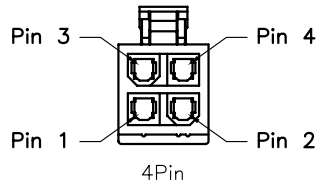
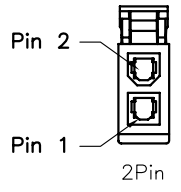
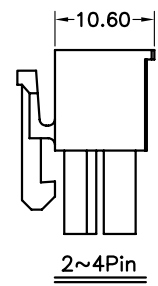
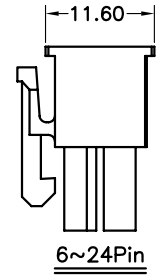

2~24Pin 防呆示意圖(Ref.)

RoHS Compliant

F			
E			
D			
C			
B	12-Jan-2012	ECN-CN1201006	Andrew
A	03-Nov-2008	(PC0001)	Tom
REV	DATE	FILE	BY

DRAWN:	Tom
CHECKED:	Jeremy Liu
APPROVAL:	Mike Wu

GENERAL TOLERANCE:	.X=±0.20 .XX=±0.15
UNIT:	MM
SCALE:	1:1
SHEET:	1 / 1
PROJECTION:	



DESCRIPTION:	4.2mm Receptacle Housing
PART NO:	2257-XX-XX-XX

SIZE  
**A4**