

REVISIONS					
SYM.	DESCRIPTION	DRFT.	CHK'D	APP.	DATE
A	RELEASED.	VR	BKS	Jt	2/2/15
B	CHANGED TO 12" LEAD LENGTH PER ECO 7502	KML	BKS	Jt	10/10/16
C	DRAFTING ERROR PER ECO 7509	KML	BKS	Jt	11/10/16

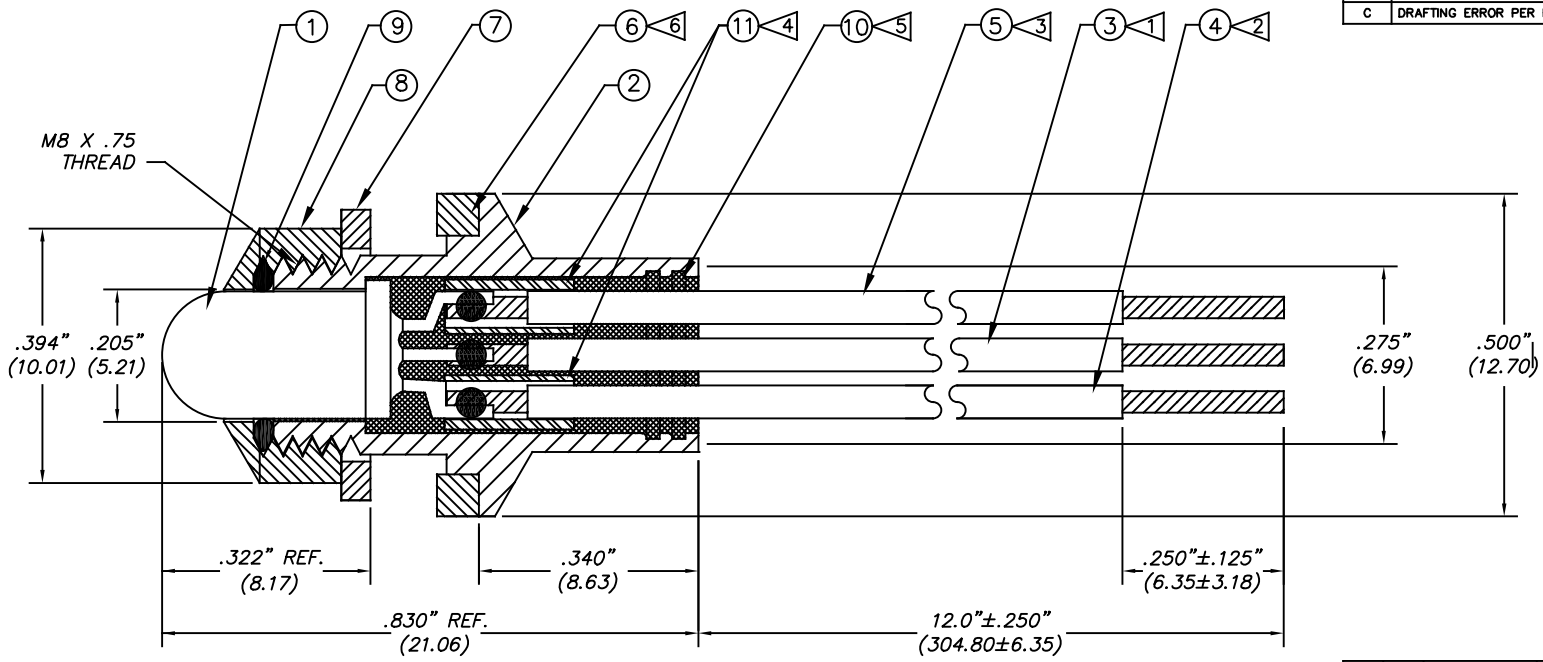

12. OPERATING VOLTAGE: 2.2 V, 20 mA.
11. OPERATING AND STORAGE TEMPERATURE RANGE: -40°C - +85°C.
10. LED AND POTTING COMPOUND SHALL WITHSTAND A PUSH OUT FORCE OF 10 LBS. MAX. EPOXY POTTING MUST REMAIN IMMOVABLE. MAX. DEFLECTION OF LED: .005 INCH (.12MM).
9. MOUNTING TORQUE SPECIFICATION: 20 Inch/lbs. ± 2 Inch/lbs. (2.26 Nm ± .23 Nm)
8. PANEL THICKNESS: .118" ± .006".
7. REAR MOUNT ASSEMBLY FITS INTO 8 MM D-SHAPE HOLE.
6. ASSEMBLE TETRASEAL GASKET (P/N: 21365-004).
5. FILL BODY WITH POTTING COMPOUND (P/N: 21048-000) (SPEC. NO. 800-100).
4. INSTALL SLEEVES (P/N: 21138-002) OVER OUTSIDE LEADS.
3. SOLDER GREEN LEAD (P/N: 21307-011) TO LED GREEN CATHODE (SHORT LEAD).
2. SOLDER RED LEAD (P/N: 21304-020) TO LED RED CATHODE (FLAT SIDE).
1. SOLDER BLACK LEAD (P/N: 21305-022) TO LED COMMON ANODE (MIDDLE LEAD).

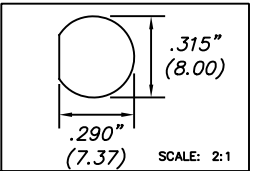

QTY.	ITEM	PART NUMBER	ASSEMBLY DESCRIPTION	MATL:
2	11	21138-002	PVC TUBING (3/8") SLEEVE	BLACK
1	10	21048-000	HYSOL EPOXY POTTING COMPOUND	X
1	9	21365-003	BUNA O-RING	X
1	8	21366-000	HEX NUT	X
1	7	21365-005	LOCK WASHER	SPLIT
1	6	21365-004	TETRASEAL GASKET	BLACK
1	5	21307-011	24 AWG MIL-SPEC WIRE	GREEN
1	4	21304-020	24 AWG MIL-SPEC WIRE	RED
1	3	21305-022	24 AWG MIL-SPEC WIRE, CATHODE	BLACK
1	2	21363-000	REAR MOUNT BODY	CHROME
1	1	21009-005	T-1 3/4 BI-COLOR TRI-LEAD LED	RED/GREN

UNIT TOOL #. X	LIST OF MATERIALS:		
BASE TOOL #. X	THIS DRAWING OR SPECIFICATION IS THE EXCLUSIVE PROPERTY OF WILBRECHT LEDCO, INC. COPIES ARE ISSUED IN STRICT CONFIDENCE AND SHALL NOT BE REPRODUCED OR COPIED, OR DISCLOSED TO OTHERS, OR USED AS THE BASIS FOR THE MANUFACTURE OR SALE OF APPARATUS WITHOUT PERMISSION.		
DO NOT SCALE DRAWING. TOLERANCES UNLESS OTHERWISE SPECIFIED;	MATERIAL:		HEAT TREATMENT:
DECIMAL .xxxx =	FINISH:		
DECIMAL .xxx = ±.005	TITLE REAR MOUNT ASSEMBLY: CRM1-0905-0000 I SPL. CRM1-PTK0111B 12.0" LDS.		
FRACTION ±	DWG. NO. 77900-139		
ANGULAR ±	REV. C		
SCALE: S:1 DATE 2/2/15	SHEET 1 OF 1		
DRAWN V. Ranney	WILBRECHT LEDCO, INC. ST. PAUL, MINNESOTA		
CHECKED	SHEET 1 OF 1		
PROD. ENG. BKS 2/2/15	SHEET 1 OF 1		
APPROVED Jt 2/2/15	SHEET 1 OF 1		
PROCESS NO. X	SHEET 1 OF 1		

NOTES: