

LTR	REVISION	DATE	APPD
-	RELEASED	10-06-17	

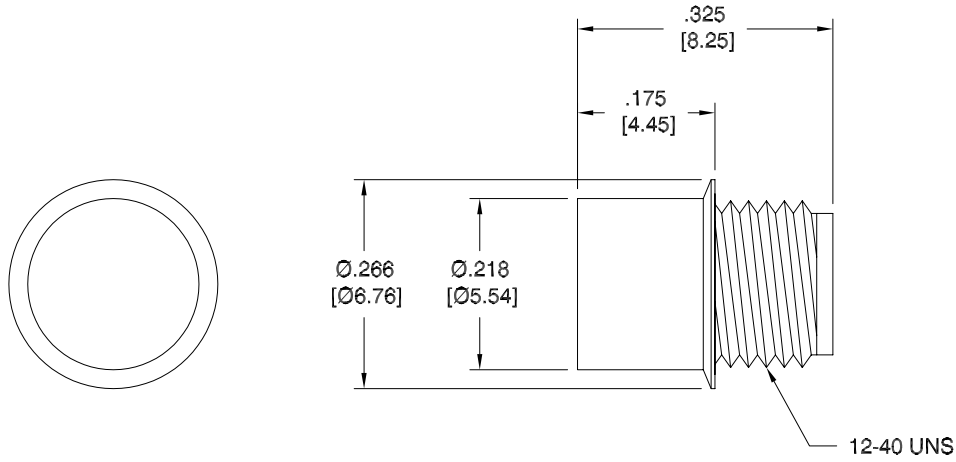

ACTUAL SIZE



NOTES:

1. ALL DIMENSIONS ARE IN INCHES [MILLIMETERS].
2. LENS MATERIAL: UV STABILIZED POLYCARBONATE/LEXAN
3. THREAD MATERIAL: PLATED BRASS



LEDTRONICS PART NO.	LENS COLOR / TYPE
LENS-HL230-AT	AMBER, DIFFUSED
LENS-HL230-BT	BLUE, DIFFUSED
LENS-HL230-CC	CLEAR, SLIGHT TINT
LENS-HL230-GT	GREEN DIFFUSED
LENS-HL230-RC	RED, CLEAR
LENS-HL230-RT	RED, DIFFUSED
LENS-HL230-WC	WATERCLEAR
LENS-HL230-WT	WHITE, DIFFUSED
LENS-HL230-YT	YELLOW, DIFFUSED

REVISION NOTIFICATION	
<input type="checkbox"/>	DLC
<input type="checkbox"/>	UL/ETL
<input type="checkbox"/>	MADE IN USA
<input type="checkbox"/>	CUSTOMER _____
<input type="checkbox"/>	OTHER
REDLINE CHECKLIST	
<input type="checkbox"/>	REDLINE(YES)
<input type="checkbox"/>	DATE: _____
<input type="checkbox"/>	INITIATED BY: _____
<input type="checkbox"/>	ECR REQUIRED YES <input type="checkbox"/> NO <input type="checkbox"/>
<input type="checkbox"/>	WORK ORDER# _____



-PROPRIETARY-
 This document contains Proprietary information of LEDTRONICS, INC. It may not be copied, used or disclosed for any purpose without the prior express written consent of LEDTRONICS, INC.

.XXX ± .010 TOLERANCE PER ANSI-Y14.5
 .XX ± .025 (UNLESS OTHERWISE STATED)
 ANGLES ± 0',30'
 FRACT. ± 1/32

TITLE LENS-HL230-XX					
DWG NO CMLN0046-CUST		SCALE 4:1		SHEET 1 OF 1	
DATE 10-06-17		QA EE 10-10-17		MFG LD 10-10-17	
CODE IDENT NO. 8Z410		DWG BY GP 10-06-17		R&D KS 10-11-17	