

North America: Danboro, PA • E-mail: info@pemnet.com • Tel: +1-215-766-8853

Europe: Galway, Ireland • E-mail: europe@pemnet.com • Tel: +353-91-751714

Asia/Pacific: Singapore • E-mail: singapore@pemnet.com • Tel: +65-6-745-0660
Shanghai, China • E-mail: china@pemnet.com • Tel: +86-21-5868-3688

Part # KF2-M4-ET, Broaching Nuts - Types KF2, KFS2 - Metric

Type KF2 and KFS2 - Broaching nuts, internally threaded for mounting on PC boards.

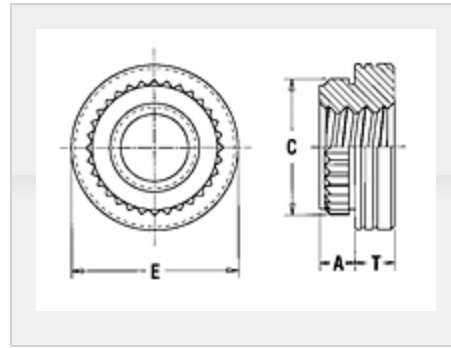

Specifications

Thread Size M4 x 0.7

Thread Code M4

A (Shank) Max. 1.53 mm

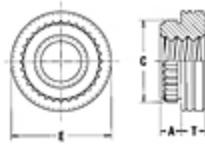

Min. Sheet Thickness 1.53 mm

Hole Size in Sheet + 0.08 6.4 mm

C ± 0.08 6.81 mm

E ± 0.13 8.74 mm

T ± 0.13 2 mm

Min. Dist. Hole C/L to Edge 6.40 mm

For Use in Sheet Hardness¹	HRB 60 / HB 107 or Less PC Board
Thread Specification	Internal, ASME B1.13M, 6H
Fastener Material	Carbon Steel
Standard Finish	Electro-Plated Tin, ASTM B545, Class B with Preservative Coating, Annealed
CAD Supplier	PennEngineering® (PEM®)

¹ HRB - Hardness Rockwell "B" Scale. HB - Hardness Brinell.