

## PG型/M型/NPT/G(PF)型尼龍六角螺母

PG Type/M Type/NPT/G(PF) Type Nylon LockNuts

## → PG/M/NPT/G(PF)



材料: 采用UL認可的尼龍材料  
 工作温度: 靜態-40°C至100°C  
 或瞬間可耐熱至120°C  
 動態-20°C至80°C  
 或瞬間可耐熱至100°C  
 顏色種類 灰色、黑色,  
 其他顏色可定做

Material: PA (NYLON), UL 94 V-2  
 Working temperature: -40°C to 100°C in static state  
 Instantaneous heat resistance up to 120°C  
 -20°C to 80°C in dynamic state  
 Instantaneous heat resistance up to 100°C  
 Color: Grey, Black,  
 other colors customized.

## ■ PROFILE

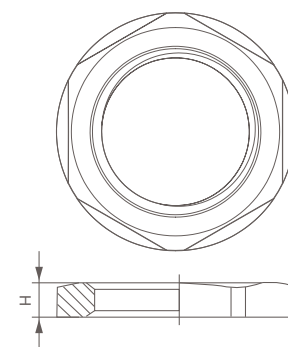

Thread	H mm	 mm	Beisit No. RAL7035	Article No. RAL7035	Beisit No. RAL9005	Article No. RAL9005
PG7	5	19	P07-LN	2.270.0701.03	P07-LNB	2.270.0703.03
PG9	5	22	P09-LN	2.270.0901.03	P09-LNB	2.270.0903.03
PG11	5	24	P11-LN	2.270.1101.03	P11-LNB	2.270.1103.03
PG13.5	5.7	27	P13-LN	2.270.1301.03	P13-LNB	2.270.1303.03
PG16	5.7	30	P16-LN	2.270.1601.03	P16-LNB	2.270.1603.03
PG21	6	36	P21-LN	2.270.2101.03	P21-LNB	2.270.2103.03
PG29	7	46	P29-LN	2.270.2901.03	P29-LNB	2.270.2903.03
PG36	7.6	60	P36-LN	2.270.3601.03	P36-LNB	2.270.3603.03
PG42	8	65	P42-LN	2.270.4201.03	P42-LNB	2.270.4203.03
PG48	7.8	70	P48-LN	2.270.4801.03	P48-LNB	2.270.4803.03
M12 x 1,5	5	17	M12-LN	2.270.1201.01	M12-LNB	2.270.1203.01
M16 x 1,5	5	22	M16-LN	2.270.1601.01	M16-LNB	2.270.1603.01
M20 x 1,5	5.7	27	M20-LN	2.270.2001.01	M20-LNB	2.270.2003.01
M25 x 1,5	6	32	M25-LN	2.270.2501.01	M25-LNB	2.270.2503.01
M32 x 1,5	7	41	M32-LN	2.270.3201.01	M32-LNB	2.270.3203.01
M40 x 1,5	7	50	M40-LN	2.270.4001.01	M40-LNB	2.270.4003.01
M50 x 1,5	8.5	60	M50-LN	2.270.5001.01	M50-LNB	2.270.5003.01
M63 x 1,5	8	75	M63-LN	2.270.6301.01	M63-LNB	2.270.6303.01
3/8"NPT	6.8	24	N38-LN	2.270.3801.06	N38-LNB	2.270.3803.06
1/2"NPT	6	27	N12-LN	2.270.1201.06	N12-LNB	2.270.1203.06
3/4"NPT	6.5	32	N34-LN	2.270.3401.06	N34-LNB	2.270.3403.06
1"NPT	7	41	N100-LN	2.270.1001.06	N100-LNB	2.270.1003.06
1 1/4"NPT	7	50	N114-LN	2.270.5401.06	N114-LNB	2.270.5403.06
1 1/2"NPT	7.6	60	N112-LN	2.270.3201.06	N112-LNB	2.270.3203.06
G(PF)1/4	5.5	19	G14-LN	2.270.1401.05	G14-LNB	2.270.1403.05
G(PF)3/8	6.8	24	G38-LN	2.270.3801.05	G38-LNB	2.270.3803.05
G(PF)1/2	6.5	27	G12-LN	2.270.1201.05	G12-LNB	2.270.1203.05
G(PF)3/4	6.5	32	G34-LN	2.270.3401.05	G34-LNB	2.270.3403.05
G(PF)1	7	41	G100-LN	2.270.1001.05	G100-LNB	2.270.1003.05
G(PF)1 1/4	7.3	50	G114-LN	2.270.5401.05	G114-LNB	2.270.5403.05
G(PF)1 1/2	8.5	60	G112-LN	2.270.3201.05	G112-LNB	2.270.3203.05
G(PF)2	9	70	G200-LN	2.270.2001.05	G200-LNB	2.270.2003.05

