

332 Time-Lag Subminiature Fuse

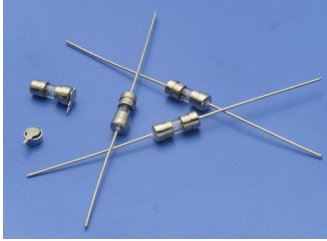

Main Characteristics

Axial subminiature fuse; Time-Lag (T)

Standard

IEC-60127-3/IV

Materials

- Tube: Glass Tube
- End Caps: Nickel plated brass
- Axial Leads: Nickel plated caps
Tin plated copper wires

Operating Temperature

-55°C to +125°C

Storage Conditions

- +10°C to +60°C
- Relative humidity: ≤75% yearly average
- Without dew, maximum 30 days at 95%

Vibration Resistance

- 24 cycles at 15 min. each (60068-6)
- 10-60Hz at 0.75mm amplitude
- 60-2000Hz at 10g acceleration

Soldering Parameters

- 260°C. ≤5 sec (Wave Soldering)
- 350°C. ≤3 sec (Hand Soldering)
- Soldering Peak:
260°C. 10 sec. (IEC 60068-20)

Average Time Current (I-T Curve)

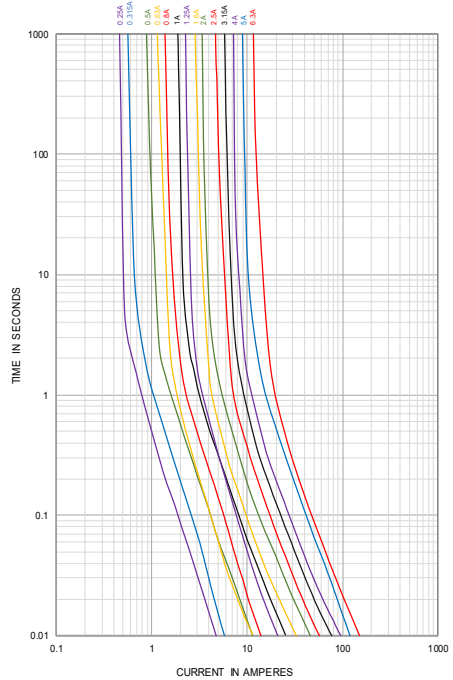

Dimensions (unit in mm)

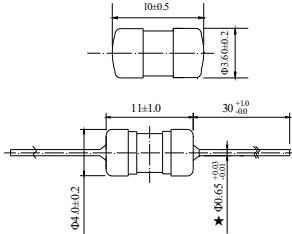

- ★ 250mA~7A: Φ0.65mm
- 8A~10A: Φ0.80mm

Time vs Current Characteristics: IEC-60127-3/IV					
Rated Current	150%	210%	275%	400%	1000%
250mA~10A	>1h	<2min	400ms~10s	150ms~3s	20ms~150ms



Electrical Characteristics

Amp Code	Rated Current	Max. Voltage	Voltage drop Max (mV)	Max. Power Dissipation (mW)	Nominal Melting I ² t(A ² sec)	Breaking Capacity	Approvals			
							PSE	TUV	CCC	cURus
0250	250mA	250V AC	240	220	0.221	50A@125V AC 35A or 10In@250VAC 50-60Hz Cosφ=1.0	○	●	○	●
0300	300mA		230	250	0.292		○	○	○	●
0315	315mA		220	250	0.336		○	●	○	●
0350	350mA		210	250	0.397		○	○	○	●
0375	375mA		210	280	0.456		○	○	○	●
0400	400mA		200	280	0.722		○	●	○	●
0500	500mA		190	310	1		○	●	●	●
0630	630mA		180	360	1.35		○	●	●	●
0750	750mA		170	430	1.82		○	○	○	●
0800	800mA		160	430	1.56		○	●	●	●
1100	1.00A		140	500	6.5		●	●	●	●
1125	1.25A		130	600	4.62		●	●	●	●
1150	1.50A		120	730	10.6		○	○	○	●
1160	1.60A		120	730	10.9		●	●	●	●
1200	2.00A		100	870	20.3		●	●	●	●
1250	2.50A		100	1000	32.5		●	●	●	●
1300	3.00A		100	1200	59.3		○	●	○	●
1315	3.15A		100	1200	74.52		●	●	●	●
1350	3.50A		100	1200	90.3		○	○	○	●
1400	4.00A		100	1400	94.1		●	●	●	●
1500	5.00A		100	1400	121		●	●	●	●
1630	6.30A	100	1400	225	○	●	●	●		
1700	7.00A	100	1400	110	○	○	○	●		
1800	8.00A	100	1400	121	○	○	●	●		
2100	10.00A	100	1400	196	50A@125V/250V AC	○	○	○	●	

Note: (1) Permissible continuous operating current is ≤100% at ambient temperature of 23°C (73.4°F)
(2) The cURus certification by 125V and 250V; the others certification by 250V.

Ordering Information

Series	Amp Code	Supplementary Code	Qty
332			