

.100 SERIES 2 ROW STRAIGHT PLUG or RECEPTACLE AND RIGHT ANGLE RECEPTACLE

M55302 / 55 Plug
M55302 / 63 Receptacle

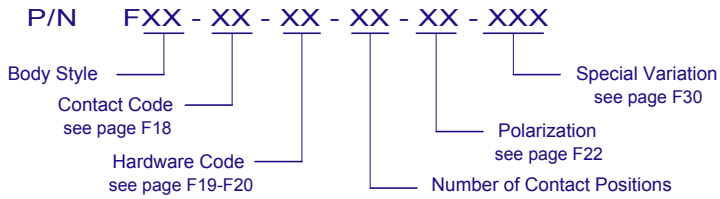

No. of Cnt's	Dimensions				
	"A"	"B"	"C"	"D"	"E"
10	1.350	.650	.400	1.100	.850
14	1.550	.850	.600	1.300	1.050
20	1.850	1.150	.900	1.600	1.350
24	2.050	1.350	1.100	1.800	1.550
26	2.150	1.450	1.200	1.900	1.650
30	2.350	1.650	1.400	2.100	1.850
36	2.650	1.950	1.700	2.400	2.150
40	2.850	2.150	1.900	2.600	2.350
44	3.050	2.350	2.100	2.800	2.550
50	3.350	2.650	2.400	3.100	2.850
54	3.550	2.850	2.600	3.300	3.050
56	3.650	2.950	2.700	3.400	3.150
60	3.850	3.150	2.900	3.600	3.350
66	4.150	3.450	3.200	3.900	3.650
70	4.350	3.650	3.400	4.100	3.850

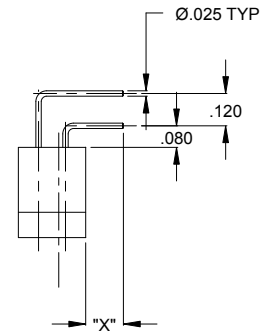
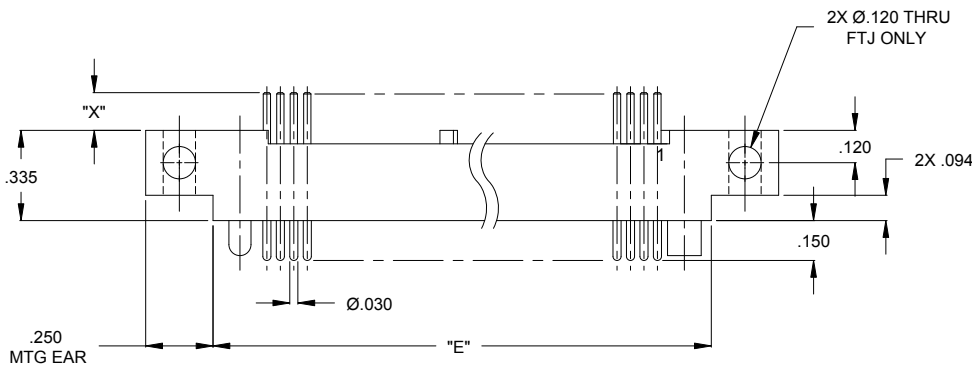
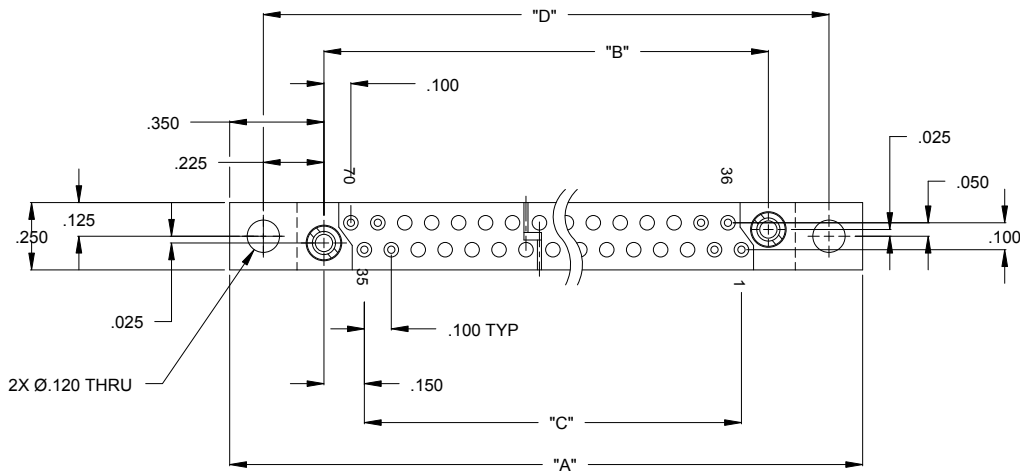

FTJ, FTG, FTF

- PLUG** | FER - AS SHOWN WITH MTG EARS
FAR - WITHOUT MTG EARS
- RECEPTACLE** | FER - AS SHOWN WITH MTG EARS
FAR - WITHOUT MTG EARS
FTG - AS SHOWN WITH MTG EARS
FTF - WITHOUT MTG EARS
FTJ - WITH MTG EARS, 2XØ.120 THRU

MATING CONNECTORS:

FBR, FDR, FTW, FTY, FKB, FKD, FKG
FKL, FKS, FKT, FKW, FKY, FTD, FTB, FTK

FBR, FDR, FKB, FKD, FKG
FKL, FKS, FKT, FKW, FKY