

CH31 Series 2.54mm(.100") Single Row Pin Headers

- Mates with CB33, CB37 and CB39
- Lead Free soldering process available

RoHS Compliant

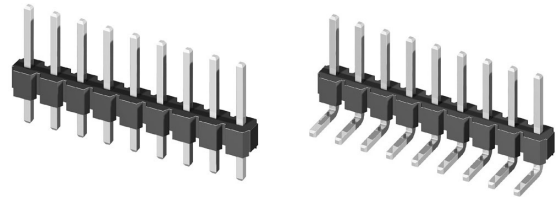

:E159616



$A = 2.54 \times \text{No. of Spaces}$
 $B = A + 2.36$

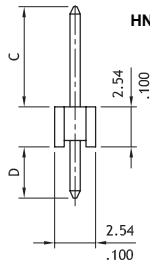
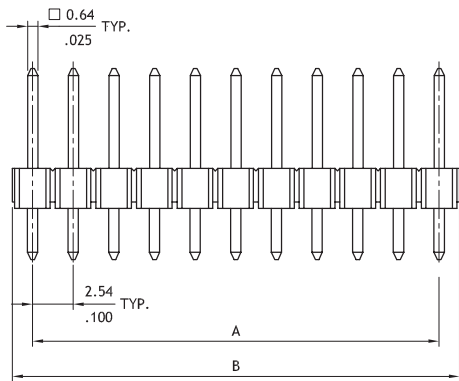

HN1X16; HN1X40

Option Code	Pin Dimension	
	C	D
00	6.0(.236)	3.00(.118)
01	6.26(.246)	3.00(.118)
02	5.86(.231)	3.00(.118)
03	8.86(.349)	3.00(.118)

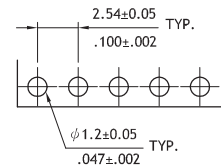

Recommended P.C. Board Layout

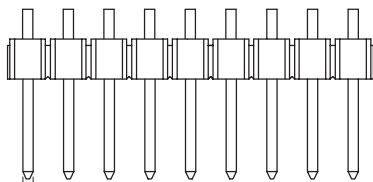

$A = 2.54 \times \text{No. of Spaces}$
 $B = A + 2.36$

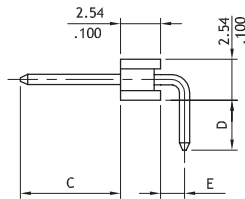
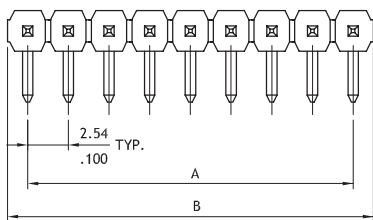

HR1X40

Option Code	Pin Dimension		
	C	D	E
00	6.0(.236)	3.00(.118)	1.5(.059)
01	6.26(.246)	3.00(.118)	1.5(.059)
02	5.86(.231)	3.00(.118)	1.5(.059)
03	8.30(.327)	3.00(.118)	1.5(.059)
04	7.26(.286)	3.00(.118)	1.5(.059)

Ordering Code

1 CH **3** **1** **2** **4** **0** **2** **V** **1** **0** **0**

- 1** Series No.
- 2** Circuits: 02 to 40
- 3** Plating code: *Optional plating available but MOQ requested
- 4** Tail Style: V= Vertical DIP Type, H= Right Angle DIP Type
- 5** Insulator material & color: 2= PBT UL 94V-0, Color Black, A= Nylon 6T UL94V-0, Color Black
- 6** Other options: 00= Standard, * See option code table, * Consult manufacturer for customized pin length