

# D38999/26 Connector Type Datasheet

TX Series • MIL-DTL-38999 Series III Style Connectors



## TX06 Cross-Reference & Compatibility

Compatible Brands	Equivalents	Mates
MIL-DTL-38999 Series III	D38999/26	D38999/20, D38999/24
Aero / Conesys	AE326	AE320, AE324
Amphenol	TV06, TVS06	TVP00, TVPS00, TVP07, TVPS07
Deutsch	DTS26	DTS20, DTS24
ITT Cannon	KJA6	KJA0, KJA7
Souriau	8D5, 8DS06G	8D0, 8D1, 8D7, 8DS00, 8DS07

## Plug Dimensions

Shell Size	Military Shell Size	W	C Thread Class 2B	L	V Thread Class 2A
9	A	.858 (21.8)	.6250-0.1P-0.3L-TS-2B	1.234 (31.3)	M12X1-6g
11	B	.984 (25.0)	.7500-0.1P-0.3L-TS-2B	1.234 (31.3)	M15X1-6g
13	C	1.157 (29.4)	.8750-0.1P-0.3L-TS-2B	1.234 (31.3)	M18X1-6g
15	D	1.280 (32.5)	1.0000-0.1P-0.3L-TS-2B	1.234 (31.3)	M22X1-6g
17	E	1.406 (35.7)	1.1875-0.1P-0.3L-TS-2B	1.234 (31.3)	M25X1-6g
19	F	1.516 (38.5)	1.2500-0.1P-0.3L-TS-2B	1.234 (31.3)	M28X1-6g
21	G	1.642 (41.7)	1.3750-0.1P-0.3L-TS-2B	1.234 (31.3)	M31X1-6g
23	H	1.768 (44.9)	1.5000-0.1P-0.3L-TS-2B	1.234 (31.3)	M34X1-6g
25	J	1.890 (48.0)	1.6250-0.1P-0.3L-TS-2B	1.234 (31.3)	M37X1-6g

Dimensions are in inches (mm).

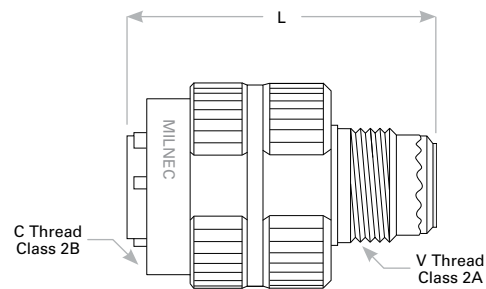
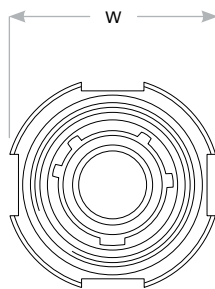

## TX06 N 13-35 P N - R2(015) - 01

- 1 **BASIC PART NUMBER**  
TX06 Plug (self-locking)
- 2 **MATERIAL & FINISH**  
N Aluminum, electroless nickel  
W Aluminum, olive drab cadmium  
K Stainless steel, passivated (firewall)
- 3 **SHELL SIZE & INSERT ARRANGEMENT**  
See Insert Arrangement Selection table, p. B-19
- 4 **CONTACT STYLE**  
P Pin  
S Socket
- 5 **ALTERNATE KEYING**  
N NORMAL or A, B, C, D, E
- 6 **OPTIONAL BACKSHELL KIT (OMIT FOR NONE)**  
B2 Straight strain relief (self-locking), p. B-35  
R2( ) Straight EMI/RFI environmental, p. B-37  
(Add dash number for appropriate shell size, see p. B-37)  
K2 Boot adapter, p. B-49, & straight shrink boot, p. B-47
- 7 **OPTIONAL ACCESSORY KIT (OMIT FOR NONE)**  
01 Protective cover

Note: See part builder (p. B-17) for additional kit options.

Rev. 1819