

未注公差/General tolerances(mm)										0.1/10			
0	>3	>6	>10	>18	>30	>50	>80	>120	>180	>250	>315	>400	±2°
~	~	~	~	~	~	~	~	~	~	~	~	>500	
3	6	10	18	30	50	80	120	180	250	315	400	500	
±0.12	±0.18	±0.22	±0.26	±0.31	±0.37	±0.57	±0.80	±0.93	±1.05	±1.15	±1.50	±2.20	±2.50

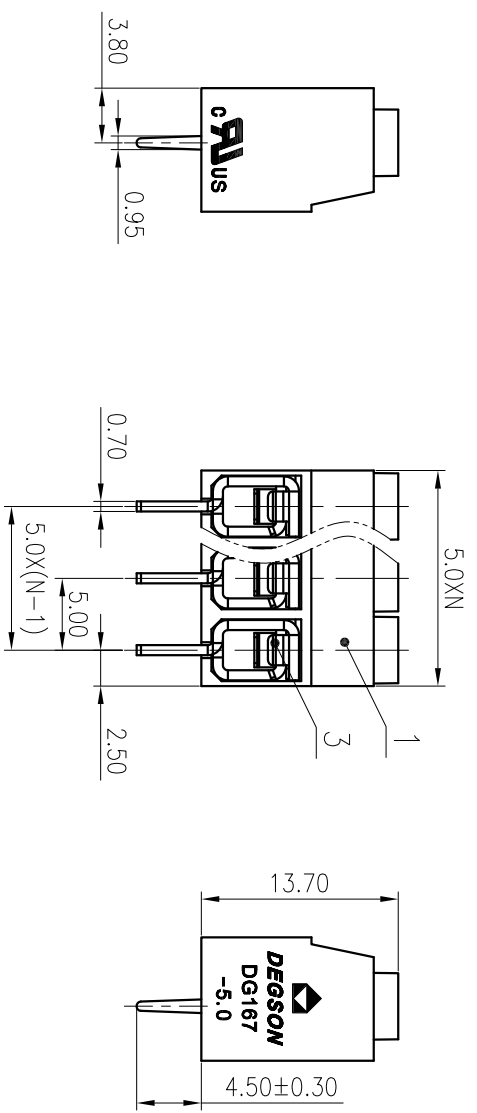

PCB LAYOUT

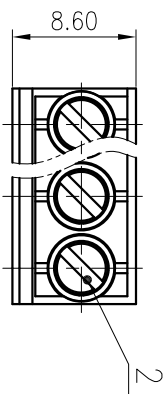
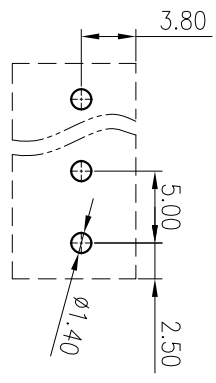

REV	ECN	DESCRIPTION	DRFT	DATE

MATERIAL:	/	SURFACE:	/
MAT NO.:	/	宁波高松电子有限公司 NINGBO DEGSON ELECTRICAL CO., LTD	
STATUS:	/	NAME: DG167-5.0-XXP-1Y-00A(H)	
APPD: LanChH	2020.05.26	DRAWING NO.: 10002118	
CHKD: YuJZ	2020.05.26	REV: TO	
DRFT: ChenZh	2020.05.26	SCALE: 2:1	
TYPE: CUSTOMER DRAWING		SHEET 1/1	

3	Pin	Copper alloy	Sn plated
2	Screw	Steel	M2.5/Zn plated
1	Housing	PA66	UL94V-0
ITEM	NAME OF PART	MATERIAL	NOTES
UL 标准/UL Standard:	B	C	D
额定电压/Rated Voltage(V)/Current(A)	300/15	/	300/10
IEC 标准/IEC Standard:	/		
过压类别/Overvoltage Category/污染等级/ Pollution Degree	III/2		
额定电压/电流/Rated Voltage(V)/Current(A)	250/22		
工频耐压/Withstanding voltage(V/1Min)	AC2000		
螺丝扭矩/Torque Tightening(N·m/Lbin)	M2.5: 0.29/2.60		
线在范围(硬线和导线)/Wire Range(rigid and flexible)(mm <sup>2</sup> /AWG)	0.5~2.5/22~12		
间距/Pitch(mm)/线数范围/Poles	5.0/N=02~12P		
剥线长度/Stripping length(mm)	6-7		
使用温度范围/Operating temperature(°C)	-40~+105		
符合RoHS环保要求/Conform to RoHS	Yes		

**Processing notes** □

Process	Wave soldering/manual soldering
---------	---------------------------------

**Connection capacity** □

Conductor cross section solid	0.5~2.5mm <sup>2</sup>
Conductor cross section flexible	0.5~2.5mm <sup>2</sup>
AWG	22~12AWG
Strip length	7mm

**Electrical parameters UL** □

Rated voltage (B)	300V
Rated voltage (D)	300V
Rated current (B)	15A
Rated current (D)	10A

**Electrical parameters IEC** □

Rated voltage	250V
Rated current	22A
Rated voltage(III/2)	250V
Rated surge voltage(III/2)	2KV

**Item properties** 

Connection direction	0°
Type of installation	PCB welding
Pin arrangement	Single row in a straight line
Connection method	Screw connection with wire protection
Screwdriver	Slotted screwdriver
screw thread	M2.5
Pitch	5mm
Number of potentials	2
Pluggable or not	no
Number of rows	1

**Material data** 

Environmental items	Compliant with REACH/RoHS
Contact material	Copper alloy
Contact point metal surface	tin-plated
Insulation Materials	PA66
Insulating material group	I

Flammability rating	UL94V-0
<b>Mechanical tests</b> □	
Test Specification	UL1059/IEC60998
<b>Environmental data</b> □	
Ambient temperature (operation)	-40°C~105°C(depending on derating curve)

PCB terminal blocks,Rated current:22A,Rated voltage (III/2) 250V,Cross section:2.5mm<sup>2</sup>,pitch:5.0mm,connector method:screw connector with wire protection,Color:green>Contact surface :Tin