

Light Emitting Diodes

High Power LEDs

ADLHP Series



ADLHP0-8BC200-M1-L

INTRODUCTION

The Adiva High-Power LED has a wide range of applications and a uniquely designed shape and is encapsulated in water clear epoxy resin with an 8mm diameter.

WHITE

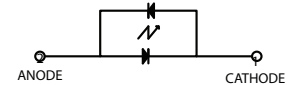
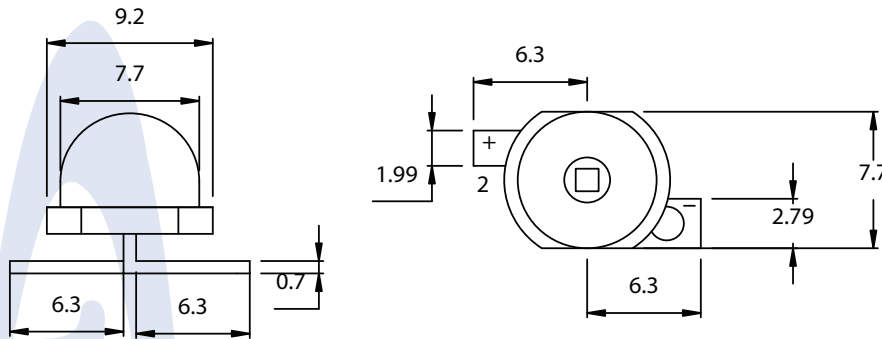

FEATURES

- High Luminous intensity, with a longer operation life.
- Excellent consistency on color, intensity and Forward Current.
- Low voltage DC operated.
- Excellent Solderability and resistance to soldering heat.
- High Reliability, 100% Probing Test.
- Low thermal resistance

ABSOLUTE MAXIMUM RATINGS

Items	Symbols	Ratings	Unit
Operation Forward Current	I_f	100	mA
Dominant wavelength	λ_D	n/a	nm
Operating Temperature Range	T_{Op}	-25 ~ 80	C
Power Dissipation	P_D	0.35	W
Reverse Current	I_{rz}	10	mA
Storage Temp. Range	T_s	-30 ~ 100	C
Soldering Temperature	T_{sol}	* 240	C

ELECTRICAL-OPTICAL CHARACTERISTICS

Parameter	Symbol	Test Condition	Min.	Typ.	Max.
Forward Voltage	V_f	$I_F=100mA$		3.4	
Reverse Current	I_r	$V_R=10V$			10
Luminous Intensity	I_m	$I_F=100mA$	15	17	19

SERIES STANDARD SPECIFICATIONS

Shape	Emitting Color	Part Number	Wavelength (nm)	Diffusion	IR(μA) VR=10V MAX	Luminous Intensity (I_m) IF=100mA Typ	Emitting Material	Viewing Angle Q (deg.)
8 ϕ	White	ADLHP0-8BC200-M1-L	X=0.32; Y=0.33	W.C.	10	15 - 19	InGaN	140

Luminous Flux

Rank	C	D	E	Unit
Flux	15 - 17	17 - 19	19 - +	I_m

Light Emitting Diodes

High Power

ADLHP Series



ADLHP0-8BC200-M1-L

WHITE

