

Light Emitting Diodes

High Power LEDs

ADLHP Series



ADLHP4-8BC200-M1-B

YELLOW

INTRODUCTION

The Adiva High-Power LED has a wide range of applications and a uniquely designed shape and is encapsulated in water clear epoxy resin with an 8mm diameter.

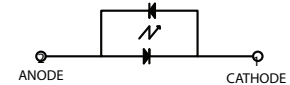
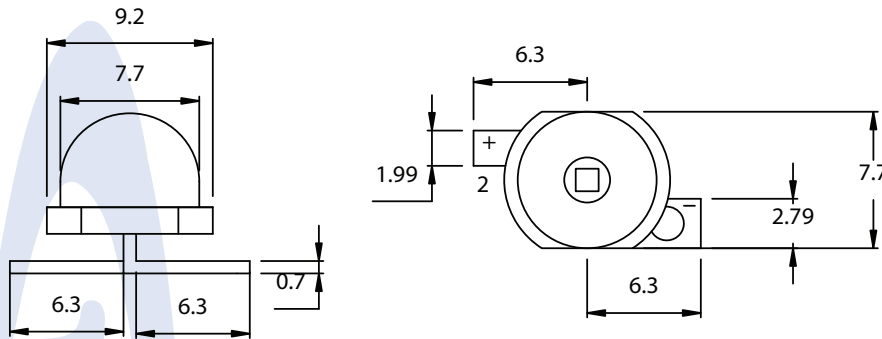

FEATURES

- High Luminous intensity, with a longer operation life.
- Excellent consistency on color, intensity and Forward Current.
- Low voltage DC operated.
- Excellent Solderability and resistance to soldering heat.
- High Reliability, 100% Probing Test.
- Low thermal resistance

ABSOLUTE MAXIMUM RATINGS

Items	Symbols	Ratings	Unit
Operation Forward Current	I_f	350	mA
Dominant wavelength	λ_D	591	nm
Operating Temperature Range	T_{Op}	-25 ~ 80	C
Power Dissipation	P_D	0.8	W
Reverse Current	I_{rz}	10	mA
Storage Temp. Range	T_s	-30 ~ 100	C
Soldering Temperature	T_{sol}	* 260	C

ELECTRICAL-OPTICAL CHARACTERISTICS

Parameter	Symbol	Conditions	Min.	Typ.	Max.
Forward Voltage	V_f	$I_F=350mA$		2.2	
Reverse Current	I_r	$V_R=10V$			10
Luminous Intensity	I_m	$I_F=350mA$		32	

SERIES STANDARD SPECIFICATIONS

Shape	Emitting Color	Part Number	Wavelength (nm)	Diffusion	IR(μA) VR=10V MAX	Luminous Intensity (I_m) IF=350mA Typ	Emitting Material	Viewing Angle Q (deg.)
8 ϕ	Yellow	ADLHP4-8BC200-M1-B	591	W.C.	10	32	InGaN	140

BIN RANKINGS

Rank	a	b	c	Unit
λ_D	587 - 590	590 - 593	593 - 596	nm

Light Emitting Diodes

High Power

ADLHP Series



ADLHP4-8BC200-M1-B

YELLOW

Luminous Flux vs Forward Current

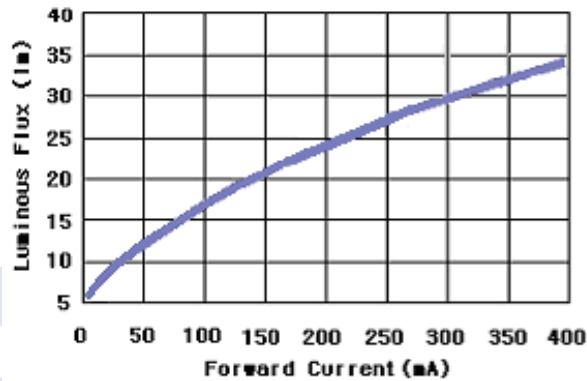

Dominant Wavelength vs Forward Current

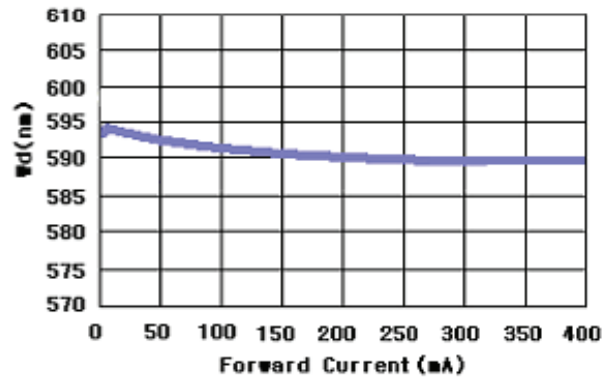

Relative Intensity vs Wavelength

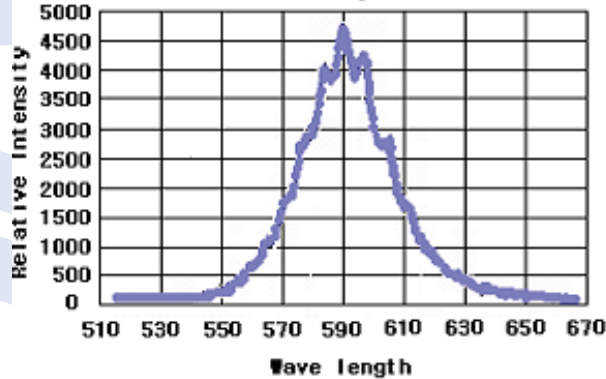

Forward Voltage vs Forward current

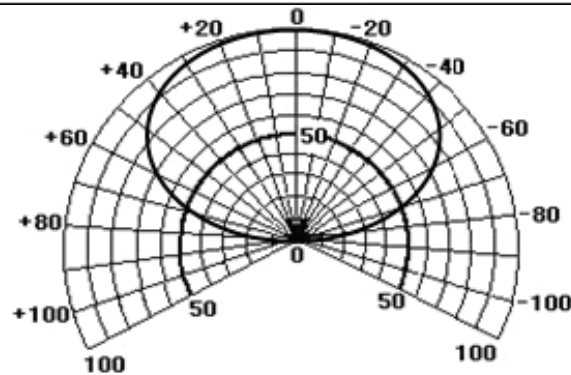
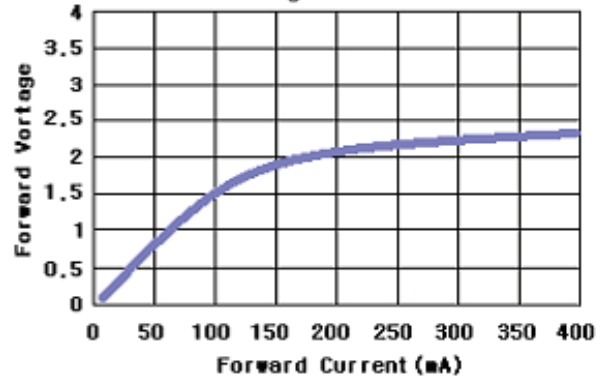

Directive Characteristics