

Light Emitting Diodes

Surface Mount LEDs

ADLSM Series



ADLSM0-3528-C200-Sx

INTRODUCTION

The Adiva Surface Mount LED has a wide range of applications and a very small size enabling it to be used in a variety of advanced technological equipment such as cellular phones, PDAs, portable MP3 players and indicator lights. The brightness makes it a perfect choice for cellphone camera flashes.

WHITE

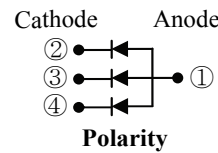
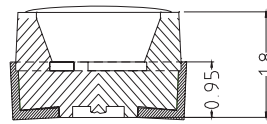
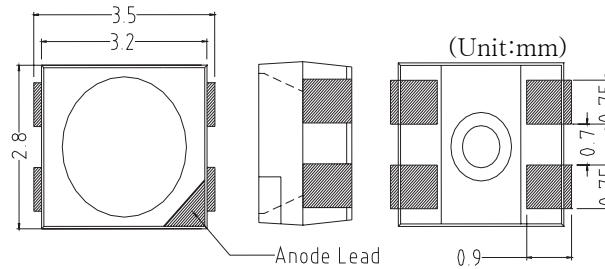
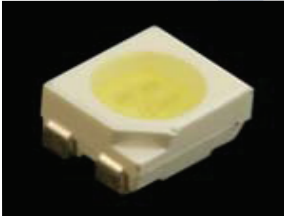

FEATURES

- High Luminous intensity, with a longer operation life.
- Compact package
- Excellent Solderability and resistance to soldering heat.
- High Reliability, 100% Probing Test.
- Low thermal resistance

ABSOLUTE MAXIMUM RATINGS

Items	Symbols	Ratings	Unit
Operation Forward Current	I_f	20	mA
Dominant wavelength	λ_D	0.31/0.35	coord.
Operating Temperature Range	T_{Op}	-25 ~ 80	C
Power Dissipation	P_D	75	mW
Reverse Voltage	V_r	5	V
Storage Temp. Range	T_s	-30 ~ 100	C
Soldering Temperature	T_{sol}	* 240	C

RECOMMENDED SOLDERING PATTERN

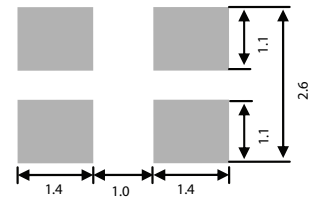

ELECTRICAL-OPTICAL CHARACTERISTICS

Parameter	Symbol	Conditions	Min.	Typ.	Max.
Forward Voltage	V_f	IF=20mA	2.9	--	3.5
Wavelength	coord.	IF=20mA	0.29/0.315		0.33/0.385
Luminous Intensity	mcd	IF=20mA	200	700	1200

SERIES STANDARD SPECIFICATIONS

Shape	Emitting Color	Part Number	Wavelength (coord.)	Diffusion	IR(μ A) VR=10V MAX	Luminous Intensity (lm) IF=120mA Typ	Emitting Material	Viewing Angle Θ (deg.)
3528	White	ADLSM0-3528-C200-Sx	(0.31/.35)	W.C.	100	10.0	InGaAlN	120

Bin Ranking	S1	S2	S3
IV (mcd)	200 - 400	400 - 600	800 - 1200