

IBS Electronics, Inc.

3506 Lake Center Dr. Santa Ana, CA 92704 USA

POT CORE

P/N: 1811 PL 003 C 85 - 1811 PL 00-3C81 MANUFACTURER: SEI

Electrical Data

Ungapped Pot Cores

CORE PART NO.	A_L ± 25%	μ_r (REF.)	A_w min ± 3200G & 100°C	Maximum Power Losses †		
1811PL00-3C81	4000	1950	2300	.18W		
1811PL00-3C85	3100	1510	2300	.18W	.22W	
1811PL00-3F3	2850	1350	2300	.13W	.22W	
1811PL00-3E2A	7500	3570				
1811PL00-3B7	3680	1740				
1811PL00-3B9	2630	1250				
1811PL00-3D3	1400	685				
1811PL00-4C6	210	100				

CORE DIMENSIONS (mm)

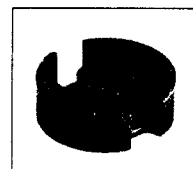

IN STOCK

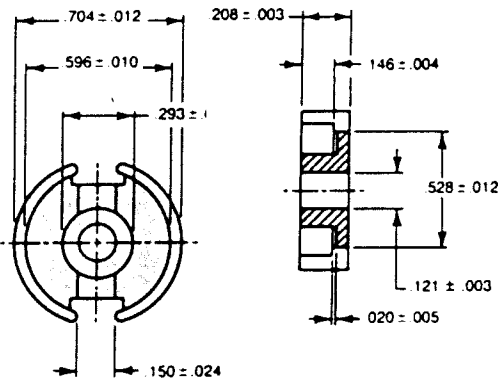

Mechanical Data Effective Core Set Parameters

MAGNETIC PATH LENGTH	ℓ_c	1.02 in. 2.58 cm
CORE CONSTANT	$\Sigma \frac{\ell_c}{A_c}$	15.22 in. ⁻¹ 5.91 cm ⁻¹
EFFECTIVE CORE AREA	A_e	.067 in. ² .433 cm ²
EFFECTIVE CORE VOLUME	V_e	.068 in. ³ 1.12 cm ³
WEIGHT		226 oz. 6.4 Grams

NOTE: MINIMUM CORE AREA .347 cm²

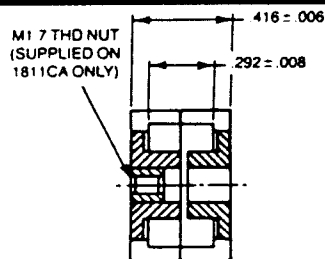

P/N: B65517 - D-R30 MANUFACTURER: SEI

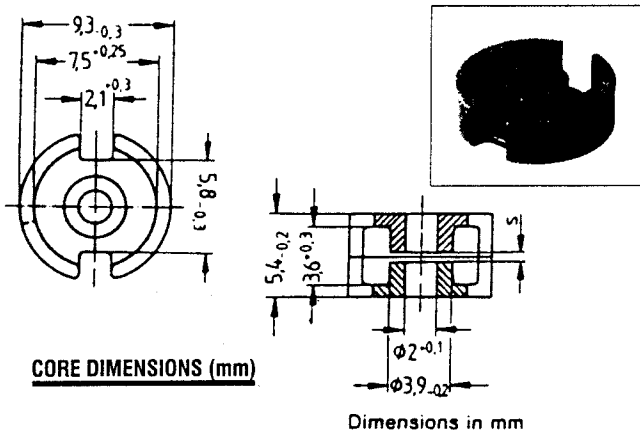

CORE DIMENSIONS (mm)

Dimensions in mm

P/N: MX 481 / 160 / Q3 MANUFACTURER: SEI

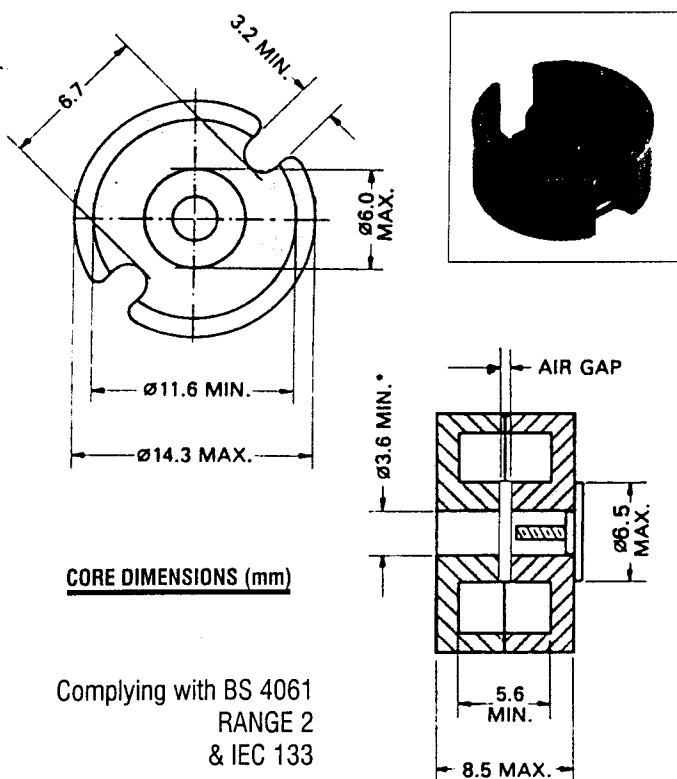

CORE DIMENSIONS (mm)

Complying with BS 4061
RANGE 2
& IEC 133

CORE PAIR WEIG

*Ø3.5 MIN. FOR MX CORES

Material	A_L value nH	Tolerance %	s approx. mm	μ_s	Ordering code ²⁾	PU Sets
Gapped						
U 17 ¹⁾	10	±3	1.20	10.0	B65517-D10-A17	500
K 12	16	±3	0.80	15.9	B65517-+16-A12	☐
K 1	25	±3	0.45	24.9	B65517-+25-A1	☐
	40		0.26	39.8	B65517-+40-A1	☐
M 33	40	±3	0.37	39.8	B65517-+40-A33	☐
	63		0.20	63	B65517-+63-A33	☐
N 48	100	±3	0.10	100	B65517-+100-A48	☐
	160		0.08	159	B65517-+160-A48	☐
	200		0.04	200	B65517-+200-A48	☐
N 26	250	±10	0.03	249	B65517-D250-K26	☐
Ungapped						
K 1	95	+30/-20		95	B65517-D-R1	☐ 500
N 26	1200	+30/-20		1190	B65517-D-R26	☐
N 30	2500	+30/-20		2490	B65517-D-R30	☐
T 38	5000	+40/-30		4970	B65517-D-Y38	☐

TOLL FREE: 800-527-2888

SEE US ON THE INTERNET
Http://www.ibs-elec.com

ISO9002
CERTIFIED

INTERNATIONAL TOLL FREE NUMBER
AVAILABLE FOR O.E.M. UPON REQUEST

