

Y08JS Series (Two Electrode)

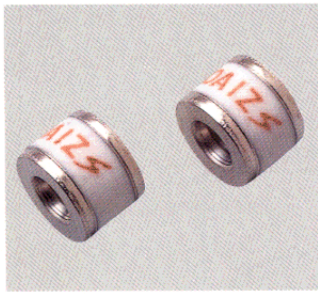

Model A Fig.1

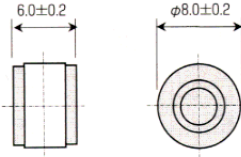

Body : Nickel Plated
Unit Weight : 1.5g

Units : mm



Model AF1 Fig.2

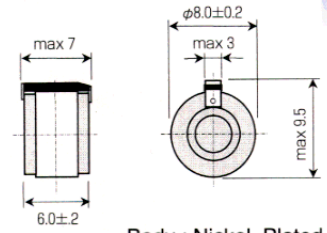

Body : Nickel Plated
Unit Weight : 1.5g

Units : mm

Model B Fig.3

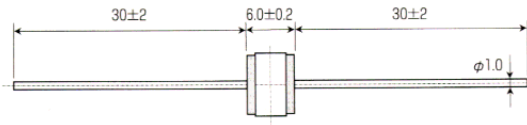

Electrodes : Nickel Plated
Leads : Tin Plated
Unit Weight : 1.9g

Units : mm

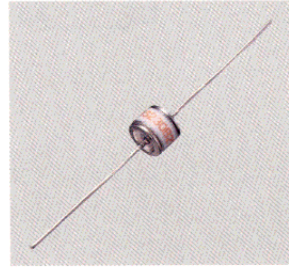

Note :

1. Insulation Resistance shall be measured with the following voltages for each nominal DC Sparkover Voltage.

| Nominal DC Sparkover Voltage | Measuring Voltage |
|------------------------------|-------------------|
| 90~145V | DC 50V |
| 230~350V | DC 100V |

Model YX Fig.4

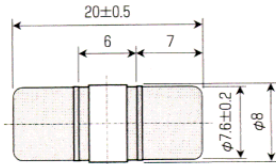

Electrodes : Nickel Plated
Leads : N/A
Unit Weight : 4.0g

Units : mm



2. DC Holdover Voltage shall be measured in accordance with the ITU-T K.12, Test Circuit or the IEEE C62.31-1987 Test Circuit.

3. Fail-Safe Operation Time
50Hz 0.7A : 210sec.
2.0A : 60sec.
7.0A : Instantaneous

4. Capacitance of Y08JS-230AF1 : ≤ 3.5pF

| Part Number | Model A : Without leads | See Fig. 1 | Y08JS-90A | Y08JS-145A | Y08JS-230A | Y08JS-250A | Y08JS-350A |
|-------------|---|------------|------------|-------------|--------------|-------------|-------------|
| | Model B : With leads | See Fig. 3 | Y08JS-90B | Y08JS-145B | Y08JS-230B | Y08JS-250B | Y08JS-350B |
| | Model AF1 : With Fail-Safe (See Note 3) | See Fig. 2 | | | Y08JS-230AF1 | | |
| | Model YX | See Fig. 4 | Y08JS-90YX | Y08JS-145YX | Y08JS-230YX | Y08JS-250YX | Y08JS-350YX |

| | | | | | | |
|------------------------------------|---|------------|------------|-----------------------|------------|------------|
| DC Sparkover Voltage | 100V/s | 70 - 110V | 115 - 175V | 180 - 280V | 200 - 300V | 290 - 430V |
| Impulse Sparkover Voltage | 100V/μs | ≤ 700V | ≤ 700V | ≤ 700V | ≤ 700V | ≤ 700V |
| | 1kV/μs | ≤ 800V | ≤ 800V | ≤ 800V | ≤ 800V | ≤ 800V |
| Insulation Resistance | See Note 1 | ≥ 10,000MΩ | ≥ 10,000MΩ | ≥ 10,000MΩ | ≥ 10,000MΩ | ≥ 10,000MΩ |
| Capacitance | 1MHz | ≤ 1.5pF | ≤ 1.5pF | ≤ 1.5pF See Note 4 | ≤ 1.5pF | ≤ 1.5pF |
| DC Holdover Voltage | See Note 2 | ≤ 52V | ≤ 52V | ≤ 52V | ≤ 52V | ≤ 52V |
| Impulse Life | 10/1000 μs, 100A | 300 times | 300 times | 300 times | 300 times | 300 times |
| Impulse Discharge Current, 8/20 μs | Single | 20kA | 20kA | 20kA | 20kA | 20kA |
| | Repeat 10 times (5 times - each polarity) | 15kA | 15kA | 15kA | 15kA | 15kA |
| AC Discharge Current, 50Hz | Single, 9 Cycles | 90A | 90A | 90A | 90A | 90A |
| | Repeat 1 sec. 10 times | 20A | 20A | 20A | 20A | 20A |

Y08U and Y08UZ Series (Two Electrode)

U-Series (UL Approved)



Model A : Without Leads

Fig.1

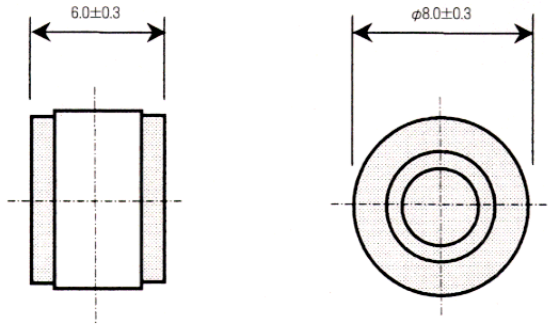

Body : Nickel Plated
Unit Weight : 1.3g

Units : mm

| Part Number | Standard P/N | Model A : | Without leads | See Fig. 1 | Y08U-75A | Y08U-90A | Y08UZ-145A |
|------------------------------------|-------------------------------|-----------|--|--------------|-----------------|-----------------|-------------------|
| | | Model B : | With leads | See Fig. 2 | Y08U-75B | Y08U-90B | Y08UZ-145B |
| | UL Approved P/N See Note 3 | Model A : | Without leads | See Fig. 1 | U-1A | U-2A | U-3A |
| | | Model B : | With leads | See Fig. 2 | U-1B | U-2B | U-3B |
| DC Sparkover Voltage | | | 100V/s | 75V ± 20% | 90V ± 20% | 145V ± 15% | |
| Impulse Sparkover Voltage | | | 100V/μs | ≤ 500V | ≤ 500V | ≤ 500V | |
| | | | 1kV/μs | ≤ 700V | ≤ 700V | ≤ 700V | |
| Insulation Resistance | | | See Note 1 | ≥ 10,000MΩ | ≥ 10,000MΩ | ≥ 10,000MΩ | |
| Capacitance | | | 1MHz | ≤ 1.0pF | ≤ 1.0pF | ≤ 1.0pF | |
| DC Holdover Voltage | | | See Note 2 | ≤ 52V | ≤ 52V | ≤ 80V | |
| Impulse Life | | | 10/1000 μs, 500A | 300 times | 300 times | 300 times | |
| Impulse Discharge Current, 8/20 μs | | | Single | 10kA | 10kA | 10kA | |
| | | | Repeat 10 times (5 times each polarity) | 5kA | 5kA | 5kA | |
| AC Discharge Current, 50Hz | | | Single, 9 Cycles | 65A | 65A | 65A | |
| | | | Repeat 1 sec. | 10A, 5 times | 10A, 5 times | 10A, 5 times | |

Y08U and Y08UZ Series (Two Electrode)

U-Series (UL Approved)

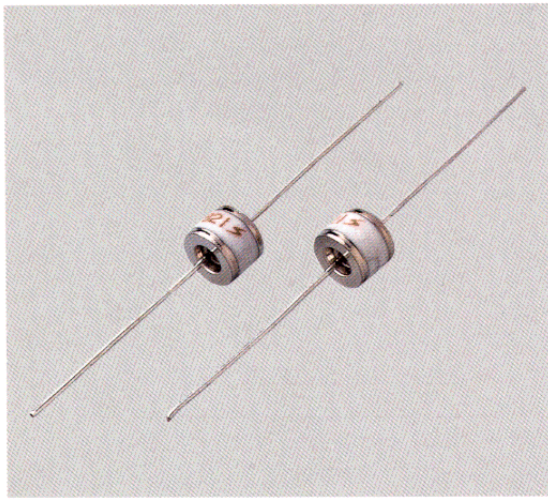

Model B : With Leads Fig.2

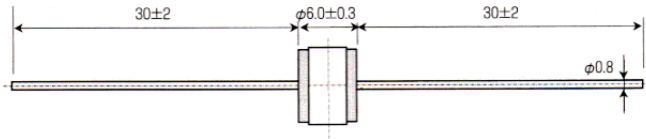

Electrodes : Nickel Plated
Leads : Tin Plated
Unit Weight : 1.6g

Units : mm

Note :

1. Insulation Resistance shall be measured with the following voltages for each nominal DC Sparkover Voltage.

| Nominal DC Sparkover Voltage | Measuring Voltage |
|------------------------------|-------------------|
| 75~145V | DC 50V |
| 230~400V | DC 100V |
| 470~800V | DC 250V |

2. DC Holdover Voltage shall be measured in accordance with the ITU-T K.12, Test Circuit or the IEEE C62.31-1987 Test Circuit.

3. Recognized under UL497B, File Number E140906.

| Y08UZ-230A | Y08UZ-250A | Y08UZ-300A | Y08UZ-350A | Y08UZ-400A | Y08UZ-470A | Y08UZ-600A | Y08UZ-800A |
|------------|------------|------------|------------|------------|------------|------------|------------|
| Y08UZ-230B | Y08UZ-250B | Y08UZ-300B | Y08UZ-350B | Y08UZ-400B | Y08UZ-470B | Y08UZ-600B | Y08UZ-800B |
| U-4A | U-5A | U-6A | U-7A | U-8A | U-9A | U-10A | U-11A |
| U-4B | U-5B | U-6B | U-7B | U-8B | U-9B | U-10B | U-11B |

| | | | | | | | |
|--------------|---------------|---------------|---------------|---------------|---------------|---------------|---------------|
| 230V ± 15% | 250V ± 15% | 300V ± 15% | 350V ± 15% | 400V ± 15% | 470V ± 15% | 600V ± 15% | 800V ± 15% |
| ≤ 600V | ≤ 600V | ≤ 700V | ≤ 700V | ≤ 700V | ≤ 700V | ≤ 800V | ≤ 1,000V |
| ≤ 750V | ≤ 800V | ≤ 850V | ≤ 850V | ≤ 850V | ≤ 850V | ≤ 1000V | ≤ 1,200V |
| ≥ 10,000MΩ | ≥ 10,000MΩ | ≥ 10,000MΩ | ≥ 10,000MΩ | ≥ 10,000MΩ | ≥ 10,000MΩ | ≥ 10,000MΩ | ≥ 10,000MΩ |
| ≤ 1.0pF | ≤ 1.0pF | ≤ 1.0pF | ≤ 1.0pF | ≤ 1.0pF | ≤ 1.0pF | ≤ 1.0pF | ≤ 1.0pF |
| ≤ 135V | ≤ 135V | ≤ 150V | ≤ 150V | ≤ 150V | ≤ 150V | ≤ 150V | ≤ 150V |
| 300 times | 500 times | 500 times | 500 times | 500 times | 500 times | 500 times | 500 times |
| 10kA | 10kA | 10kA | 10kA | 10kA | 10kA | 10kA | 10kA |
| 5kA | 5kA | 5kA | 5kA | 5kA | 5kA | 5kA | 5kA |
| 65A | 65A | 65A | 65A | 65A | 65A | 65A | 65A |
| 10A, 5 times | 10A, 10 times | 10A, 10 times | 10A, 10 times | 10A, 10 times | 10A, 10 times | 10A, 10 times | 10A, 10 times |