

# Molded Chokes

Axial Led Thru Hole

ADMC Series



## FEATURES

- Low cost.
- High Q and SRF, Low RDC.
- Permanent Color Band.

ADMC

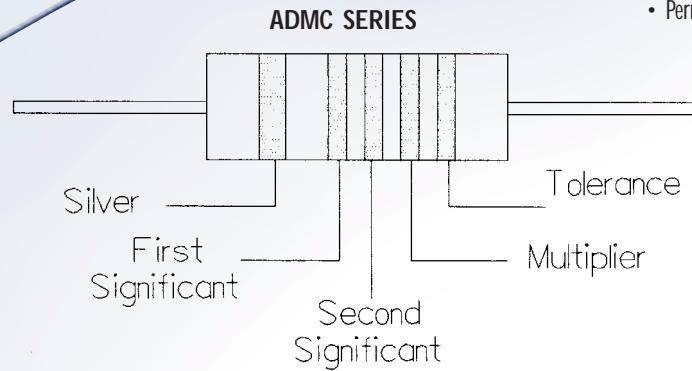
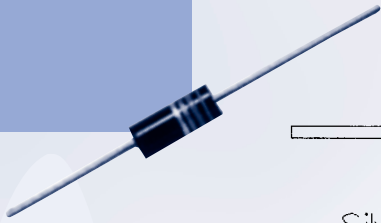

INDUCTANCE VALUES ARE INDICATED WITH COLOR CODE AS SHOWN BELOW.  
FIRST SILVER COLOR CODE MEANS AMERICAN MILITARY SPECIFICATION TYPE.

## PART NUMBERING GUIDE

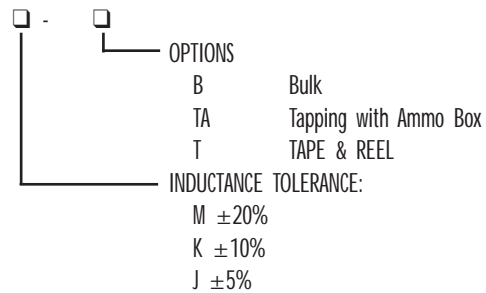
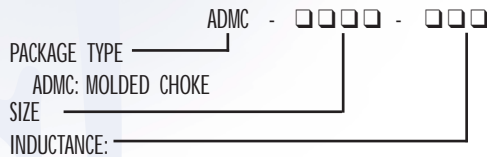

## STANDARD SPECIFICATIONS

COLOR CODE	FIRST SIGNIFICANT FIGURE	SECOND SIGNIFICANT FIGURE	MULTIPLIER	INDUCTANCE TOLERANCE (%)
Black	0	0	1	-
Brown	1	1	10	-
Red	2	2	100	-
Orange	3	3	1000	-
Yellow	4	4	-	-
Green	5	5	-	-
Blue	6	6	-	-
Violet	7	7	-	-
Gray	8	8	-	-
White	9	9	-	-
Black (M)	-	-	-	±20
Gold (J)	-	-	0.1	±5
Silver (K)	-	-	0.01	±10



# Molded Chokes

Axial Led Thru Hole

ADMC Series — Continued

ADMC

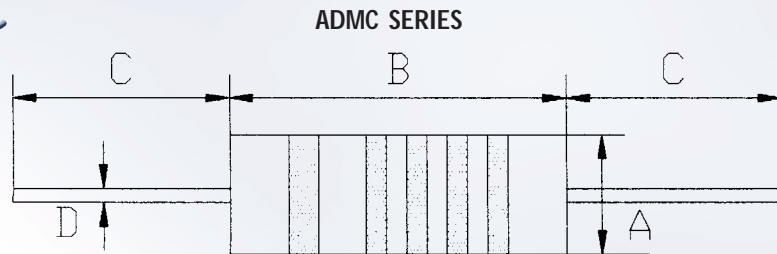
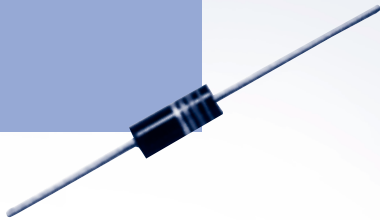

## STANDARD SPECIFICATIONS

PACKAGE TYPE	Ø A (mm)	B (mm)	C (mm)	Ø D (mm)
ADMC-4812	4.83 ±0.25	11.18 ±0.25	25.91 (min.)	0.635 ±0.05
ADMC-2434	2.41 ±0.25	3.35 ±0.25	25.91 (min.)	0.500 ±0.05
ADMC-4095	3.96 ±0.25	9.53 ±0.25	25.91 (min.)	0.600 ±0.05
ADMC-6515	6.50 ±0.10	14.50 ±0.25	25.91 (min.)	0.800 ±0.05
ADMC-2051	1.98 ±0.25	5.08 ±0.25	25.91 (min.)	0.410 ±0.05
ADMC-4110	4.11 ±0.25	10.41 ±0.25	25.91 (min.)	0.600 ±0.05

## INDUCTANCE & RATED CURRENT RANGES

PACKAGE TYPE	INDUCTANCE		RATED CURRENT	
	µH	µH	mA	mA (max.)
ADMC-4812	0.15	1000	3050	78
ADMC-2434	0.10	1000	1380	28
ADMC-4095	0.15	1000	2740	82
ADMC-6515	0.10	1000	1900	80
ADMC-2051	0.10	270	895	39
ADMC-4110	0.10	10000	1790	24

# Molded Chokes

Axial Leaded Thru Hole

ADMC-2051 Series



**ADMC-2051**

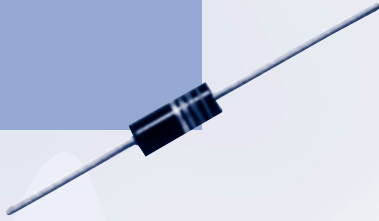

ADMC SERIES

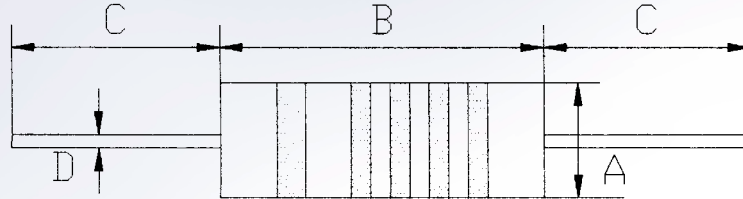

## PACKAGE TYPE

PACKAGE TYPE	Ø A (mm)	B (mm)	C (mm)	Ø D (mm)
ADMC-2051	1.98 ±0.25	5.08 ±0.25	25.91 (min.)	0.410 ±0.05

## STANDARD SPECIFICATIONS

ORDERING CODE	INDUCTANCE (L)	Q min.	FREQUENCY (MHz)	SELF-RESONANT FREQUENCY (MHz) min.	RDC (Ω) max.	IDC (mA) max.
ADMC-2051-R10 □□	0.10 uH	35	25	680	0.13	895
ADMC-2051-R12 □□	0.12 uH	35	25	650	0.15	835
ADMC-2051-R15 □□	0.15 uH	35	25	560	0.18	760
ADMC-2051-R18 □□	0.18 uH	35	25	540	0.21	705
ADMC-2051-R22 □□	0.22 uH	30	25	500	0.25	645
ADMC-2051-R27 □□	0.27 uH	30	25	440	0.38	525
ADMC-2051-R33 □□	0.33 uH	25	25	410	0.49	460
ADMC-2051-R39 □□	0.39 uH	25	25	380	0.59	420
ADMC-2051-R47 □□	0.47 uH	25	25	340	0.62	410
ADMC-2051-R56 □□	0.56 uH	40	25	250	0.18	510
ADMC-2051-R68 □□	0.68 uH	40	25	215	0.20	485
ADMC-2051-R82 □□	0.82 uH	40	25	200	0.22	465
ADMC-2051-1R0 □□	1.00 uH	40	25	190	0.25	435
ADMC-2051-1R2 □□	1.20 uH	35	7.9	170	0.28	410
ADMC-2051-1R5 □□	1.50 uH	40	7.9	150	0.49	310
ADMC-2051-1R8 □□	1.80 uH	40	7.9	135	0.56	290
ADMC-2051-2R2 □□	2.20 uH	45	7.9	130	0.72	257
ADMC-2051-2R7 □□	2.70 uH	45	7.9	110	0.85	236
ADMC-2051-3R3 □□	3.30 uH	45	7.9	100	1.20	198
ADMC-2051-3R9 □□	3.90 uH	50	7.9	95	1.50	178
ADMC-2051-4R7 □□	4.70 uH	55	7.9	88	2.10	150
ADMC-2051-5R6 □□	5.60 uH	55	7.9	78	2.80	130
ADMC-2051-6R8 □□	6.80 uH	55	7.9	69	3.20	122
ADMC-2051-8R2 □□	8.20 uH	45	7.9	52	4.40	104
ADMC-2051-100 □□	10.00 uH	45	7.9	47	5.20	95
ADMC-2051-120 □□	12.00 uH	40	2.5	31	3.00	126
ADMC-2051-150 □□	15.00 uH	40	2.5	26	3.40	118
ADMC-2051-180 □□	18.00 uH	40	2.5	23	3.80	112
ADMC-2051-220 □□	22.00 uH	45	2.5	20	4.30	105
ADMC-2051-270 □□	27.00 uH	45	2.5	17	4.70	100
ADMC-2051-330 □□	33.00 uH	45	2.5	15	5.20	95
ADMC-2051-390 □□	39.00 uH	45	2.5	13.5	6.80	83.5
ADMC-2051-470 □□	47.00 uH	45	2.5	12.5	8.20	76
ADMC-2051-560 □□	56.00 uH	45	2.5	11.5	10.00	69
ADMC-2051-680 □□	68.00 uH	45	2.5	10.5	11.50	64
ADMC-2051-820 □□	82.00 uH	45	2.5	10	16.00	54.5
ADMC-2051-101 □□	100.00 uH	45	2.5	9.5	17.50	52
ADMC-2051-121 □□	120.00 uH	35	0.79	8.9	16.00	54.5
ADMC-2051-151 □□	150.00 uH	35	0.79	7.9	18.00	51
ADMC-2051-181 □□	180.00 uH	35	0.79	7.5	20.00	49
ADMC-2051-221 □□	220.00 uH	35	0.79	7.1	26.50	42.5
ADMC-2051-271 □□	270.00 uH	35	0.79	6.6	30.50	39

